



ArbTS - Arboricultural Technician Services Ltd

(Tree Consultancy Services)

Stephen Lucocq *BSc (Hons), Tech Cert (ArborA), M.Arbor.A*
Professional Member of the Arboricultural Association

Web site: www.ArbTS.co.uk

Email: info@ArbTS.co.uk

Mobile: 07789 551 591

Arboricultural Report

Including:

Tree Survey Data &

Tree Constraints Plan,

Arboricultural Impact Assessment,

Tree Protection Plan and Arboricultural Method Statement

To the British Standard 5837:2012
(Trees in relation to design, demolition
and construction. Recommendations)

Date – 4th February 2025

Site – Penmaen Road, Pontllanfraith, Blackwood NP12 2DY

Project Reference – ArbTS_2049.1_Penmaen Road

Table of Contents

1.0	Introduction	3
2.0	The Tree Survey	3
3.0	The Trees	4
4.0	Tree Constraints Plan Information	4
5.0	Arboricultural Impact Assessment	5
6.0	Arboricultural Method Statement	6
7.0	Conclusion	7
8.0	Qualifications & Further Information	8
9.0	Bibliography & Web Information	9
10.0	Appendix	
	1A	Tree Survey Data + 1B - Detailed Tree Survey Data Summary
	2	Tree Constraints Plan
	3	Tree Survey Key
	4	Tree Protection Plan
	5	Tree Photographs

Copyright © 2025

ArbTS - Arboricultural Technician Services Ltd, 5 Weavers Road, Ystradgynlais, Powys, SA9 1PQ. All rights reserved.

No part of this report may be copied or reproduced without prior written permission from ArbTS.

If you have received this report in error, please destroy all copies in your possession or control.

This report has been prepared for the exclusive use of the commissioning party, and unless otherwise agreed in writing by ArbTS, no other party may use, make use of or rely on the contents of this report.

ArbTS accept no liability for any use of this report other than for the purposes for which it was initially prepared and provided.

Opinions and information provided in the report are based on ArbTS using due skill, care and diligence in preparing the same. No warranty is provided as to their accuracy.

Surveys are undertaken to ensure that nothing in the final report will be omitted, amended or misrepresented by the client or any other interested party.

This report and its contents remain the property of ArbTS until payment has been made in full.

It should be noted, and it is expressly stated, that no independent verification of any of the documents or information supplied to ArbTS has been made.

1.0 Introduction

- 1.1 The purpose of this report is to assess the quality of the trees at Penmaen Road, Pontllanfraith, Blackwood NP12 2DY, assess the arboricultural impact of the proposed development design and provide details regarding the protection of retained trees during construction work.
- 1.2 This report identifies the quality of the trees on this site as categorised by the *British Standard 5837:2012, Trees in relation to design, demolition and construction - Recommendations*. The survey and findings, as reported here, represent an unbiased third-party opinion offering professional advice on the value of the trees on or adjacent to this site. To illustrate the constraints identified trees pose to the design of future development, a Tree Constraints Plan (TCP) has been drawn, as found in Appendix 2.
- 1.3 Arboricultural constraints within the surveyed site relate primarily to the preservation of trees recommended for retention. Identified trees must be protected during the construction phase by employing a combination of tree protection methods as illustrated in Appendix 4, Tree Protection Plan and detailed within Section 6 - Arboricultural Method Statement.
- 1.4 The trees' root system and the associated soil structure is often overlooked during the construction process and can be damaged or altered by compaction, causing significant damage to the health of the tree. Generally, the tree's entire root system is within the top 600mm of soil, where it can be easily damaged. A calculated ground area around the tree should be protected during the onsite construction phase. In this report, it is referred to as the Root Protection Area (RPA).

2.0 The Tree Survey

- 2.1 The tree survey was conducted by *Stephen Lucocq BSc (Hons), Tech Cert (ArborA), M.Arbor.A* on 5th December 2024.
- 2.2 Trees over 75mm were tagged where appropriate with numbered metal identification tags at around 2.0 metres above ground level.
- 2.3 All observations were made from the ground with an acoustic-sounding hammer. No invasive decay detective instruments were used.
- 2.4 The survey was carried out per *British Standard 5837:2012, Trees in relation to design, demolition and construction - Recommendations*. This standard gives a systematic, consistent, transparent evaluation method for tree surveying.
- 2.5 The tree survey was conducted with the aid of a topographical survey.
- 2.6 **Preliminary management recommendations:** The survey has identified preliminary management recommendations for the trees on or adjacent to this site. Details regarding these specified operations are given in this report (See Appendix 1 - Tree Survey Data). Where work priority is stated to be H – High due to safety reasons, these operations should be carried out as soon as possible. Where work priority is

said to be M/H – medium/high or higher, these operations should be undertaken before the commencement of any works on site.

- 2.7 **Limitations of the tree survey:** Whilst every effort is made to ensure an accurate assessment of the tree's condition during the survey, no responsibility can be taken for resultant damage or injury that occurred by a failing tree. The survey only gives a snapshot of what is visible and is not obscured on the day of the survey. The survey identifies trees of varying quality and their above-ground/below-ground constraints. This survey does not constitute a full tree condition survey/tree risk assessment of the site, and this report is only valid for 24 months from the date of the tree survey.

3.0 The Trees

- 3.1 The complete tree survey data can be found in Appendix 1A Tree Survey Data

- 3.2 Tree Survey Summary Table (See Appendix 3 for BS5837 category definitions).
(A more detailed Tree Survey Data Summary can be found in Appendix 1B)

BS5837:2012 Quality Category	Total Number of Individual Trees Surveyed	Total Number of Tree Groups Surveyed	Total Number of Tree Areas Surveyed	Total Number of Woodland Areas Surveyed	Total Number of Hedgerows Surveyed	Total
A (High - Most desirable for retention)	0	0	0	0	0	0
B (Moderate - Desirable for retention)	1	0	0	0	0	1
C (Low - Optional for retention)	2	6	0	0	0	8
U (Poor - Unsuitable for retention)	0	0	0	0	0	0
Total A,B,C,U	3	6	0	0	0	9

4.0 Tree Constraints Plan (TCP) Information

- 4.1 A Tree Constraints Plan (TCP) can be found in Appendix 2 of this report. An introduction to TCP can also be found at the start of this Appendix Section. For further information and details regarding TCP, please see the *British Standard 5837:2012, Trees in relation to design, demolition and construction – Recommendations*.

5.0 Arboricultural Impact Assessment (AIA)

5.1 The following Arboricultural Impact Assessment has been made for the proposed development design.

5.2.1 Tree Loss – AIA – LOW - The following trees are required to be removed to facilitate the construction of the proposed development design.

5.2.2 Individual Tree Loss –

- Tree T1 – Ash – Low quality (C category)
- Tree T3 – Hornbeam – Low quality (C category)

5.2.3 Grouped Tree Loss –

- Tree Group – G2 – Ash and Maple - Low quality (C category)
- Tree Group – G1 – Overgrown Leyland Cypress High Hedgerow- Low quality (C category)
- Tree Group – G4 – Overgrown Leyland Cypress Hedgerow- Low quality (C category)
- Tree Group – G3 – 3 small suppressed cherry trees - Low quality (C category)

5.2.4 Overall Tree Loss –

Several trees have been identified as being removed to facilitate the construction of the proposed development design. All of these trees identified for removal are low-quality trees (C category) with a limited future. These trees should not present a constraint on developing the site and can be readily mitigated for and enhanced by a new landscape planting scheme.

5.3 Root Protection Area (RPA) – AIA – LOW - RPA potential damage can all be managed through the installation of tree protective fencing, as designed by an Arboriculturist will ensure no significant long-term adverse impact will occur to any of the retained trees.

5.4.1 Conclusion – AIA – LOW - The site has a few Arboricultural constraints that must be considered in the development design phase. Several trees have been identified as being removed to facilitate the construction of the proposed development design. All of these trees identified for removal are low-quality trees (C category) with a limited future. These trees should not present a constraint on developing the site and can be readily mitigated for and enhanced by a new landscape planting scheme.

5.4.2 The construction of the proposed development, whilst complying with the tree protection scheme as detailed in section 6, will ensure that no significant long-term adverse Arboricultural impact occurs on the health of any retained trees on or adjacent to this site or the long-term amenity of the area.

6.0 Arboricultural Method Statement

6.1 The Tree Protection Plan to facilitate the construction of the development design can be found in Appendix 4 of this report. The Tree Protection Plan must comply with all of the following:

- Be regarded as sacrosanct and follow the sequence of events as detailed in the table below
- Be installed before commencement of any demolishing or construction works on site
- Must not be removed or altered without prior approval of the local planning authority

6.2 The following table overleaf provides a detailed sequence of events that must occur to protect the retained trees during all stages of the construction process. These methods must be communicated to the entire construction team before any work on site.

Stage	Arboricultural Method Statement (In the sequence of events)
1.) Preconstruction <i>(Prior to any on-site construction work, including demolition work, site material storage etc.)</i>	1.1 – Design areas for construction site storage by the site supervisor and the appointed Arboriculturist.
	1.2 – Design position, form and construction methods of all utility services with Arboricultural consideration. All underground service designs MUST conform to the NJUG Volume 4 Guidelines for the Planning, Installation and Maintenance of Utility Apparatus in Proximity to Trees. The full document is available at http://www.njug.org.uk/ . Local Planning Authority to be consulted on utility service design details and, if satisfied, to be approved in writing before installation during the construction phase.
	1.3– Tree surgery work to be carried out is detailed in the Tree Protection Plan (Appendix 4) of this report and to the <i>British Standard:3998:2010: Recommendation for tree works</i> .
	1.4 – Tree protective fencing installed in the position and form as detailed in the Tree Protection Plan (Appendix - 4). Installation is to be supervised by the appointed Arboriculturist. All weather tree construction exclusion zone posters are to be secured to fencing at regular intervals.
	1.5 – Site storage area containers installed as designed and supervised by the site supervisor and the appointed Arboriculturist.
	1.6 – Appointed Arboriculturist to document all tree protection methods in situ and photographs taken for reference purposes. Copy of document report sent to all parties.
2.) Construction	2.1 – The site supervisor is to be briefed by the appointed Arboriculturist regarding the Tree Protection Plan/Methods, and a laminated copy of the plan/methods is to be secured onto the wall in the site supervisor's office. Contact details of the appointed Arboriculturist, Council's Tree Officer, to be included. Emphasis is to be made to the site supervisor on the importance of the Tree Protection Plan/Methods and possible planning enforcement action (Stop Notice), problems with discharging tree protection conditions and/or legal action for noncompliance with these tree protection methods.

	2.2 – All contractors are to be briefed by the site supervisor and/or the appointed Arboriculturist regarding the tree protection plan and methods before starting work on site. Emphasis made to contractors on the importance of the Tree Protection Plan/Methods and possible planning enforcement action (Stop Notice), problems with discharging tree protection conditions and/or legal action for noncompliance with these tree protection methods.
	2.3 – The construction phase begins
	2.4 - Tree Safe Construction (Throughout site) – areas outside of the construction exclusion zones, as shown on the tree protection plan, must adhere to the following: <ul style="list-style-type: none"> • Building materials and fuels such as oil, bitumen or cement should not be stacked or discharged within 20 metres of the tree's stem. • Fires will not be lit beneath any tree or in a place where flames could extend to within 10 metres of the tree. • Trees to be retained and protected should not be used as anchorage for services or equipment. • The use of cranes and large machinery on site should be planned and care taken not to damage the trees during the process.
	2.5 – Unforeseen issues which require the alteration of the Tree Protection Plan/Methods, required tree surgery work or immediate remedial work will be submitted to the Local Planning Authority for approval in writing.
3.) Post Construction (<i>Once all construction work has been completed, this includes all utility services</i>)	3.1 – Tree Protection fencing Removed.
	3.2 – Hard and soft landscaping commence - All landscape team members are to be briefed regarding tree protections by an Arboriculturist.
	3.3 – Any required remedial tree action is taken , such as Leaf Mulch Application, soil de-compaction methods, contamination clean up etc., to be carried out.

7.0 Conclusion

- 7.1 Adhering to the tree protection details in this report, the proposed development can be constructed without any significant long-term adverse impact on the retained trees or the area's amenity.

8.0 Further Information & Qualifications

Stephen Lucocq has been involved in Arboriculture within South Wales for over twenty years. He has worked as an Arborist for many of these years and has an excellent working knowledge of the practical side of the profession. He has always taken an active interest in all areas of Arboriculture and kept up to date with current research and developments.

Qualifications

- First Class BSc (Hons) Degree – Combined Studies - Biology and IT
- Arboricultural Association Technicians Certificate – Level 4 - (Merit)
- PTI - Professional Tree Inspection (Lantra Awards)
- 2D Computer-Aided Design (City and Guilds - Level 3)
- Quantified Tree Risk Assessment (QTRA) – Mike Ellison
- Visual Tree Assessment (VTA) – Mike Ellison
- Arboriculture and Bats (Lantra)
- Industrial Rope Access Trade Association (IRATA)
- Practical Arboriculture Qualifications (NPTC)

Membership

- Arboricultural Association Professional Member (M.Arbor.A)

9.0 Web Information & Bibliography

Web Information

- Arboricultural Association
<http://www.trees.org.uk/>
- Cellular Confinement System
GeoWeb - [GreenFix](#)
CellWeb - [Geosynthetics](#) [Cellweb](#)
- Underground Utilises Installation
<http://www.njug.org.uk/>

Bibliography

- British Standards 3998 (2010) Recommendations for Tree Work UK; British Standards Intuition
- British Standard 5837:2012, Trees in relation to design, demolition and construction - Recommendations UK; British Standards Intuition
- Coombes, A.J (1992) Trees London; Dorling Kindersley
- Lonsdale, D (1999) Principle of Tree Hazard Assessment and Management Edinburgh; Forestry Commission
- Mattheck, C (2007) Field Guide for Visual Tree Assessment Germany; Karlsruhe Research Centre
- Shigo, A.L (1991) Modern Arboriculture USA; Shigo and Trees, Association
- Sterry, P (2007) Collins Complete British Trees London; Collins
- Strouts, R.G (2000) Diagnosis of ill-health in trees Edinburgh; Forestry Commission
- Weber, K & Mattheck, C (2003) Manual of wood decay UK; Arboricultural Association

10.0 Appendix 1A -Tree Survey Data

Tree ID #	Tree Species	Age	Stems	Stem Diam (mm)	Cat	Height + (Lower Branch Height)	Nrth	Est	Sth	Wst	Phys Cond	Struc Cond	Est. Remain Contrib	Comments	Preliminary Management Recommendations	Work Priority	RPR (m)	RPA (m2)	
G1	X Cupressocyparis leylandii (Leyland Cyp)	M	1	450	C2	9(0)	6	6	6	6	F	F/P	10+	overgrown boundary high hedgerow, limited value with limited future, have been past topped by pruning but sides left unmanaged and wide in form, limited management options now available, a number of structural defects noted through group			5.4	91.62	
G2	Fraxinus excelsior (Ash),Acer platanoides (Norway Maple)	SM	1	150	C2	7(0)	3	3	3	3	F	F	10+	small group of multstemmed trees			1.8	10.18	
G3	Prunus avium (Wild Cherry)	EM	1	150	C2	6(2)	2	0	2	3	F	F/P	10+	Suppressed growth from surrounding trees.			1.8	10.18	
G4	X Cupressocyparis leylandii (Leyland Cyp)	M	1	200	C2	6(0)	4	4	4	4	F	F/P	10+	overgrown boundary hedgerow, limited value with limited future, have been past topped by pruning but with southern side heavily pruned , limited management options now available			2.4	18.1	
G5	Acer pseudoplatanus (Sycamore),Fraxinus excelsior (Ash)	M	1	350	C2	13(4)	4	4	4	4	F	N/A	10+	Located on private land preventing a close inspection of the tree therefore all observations and measurements are estimated.	offsite group of sycamore			4.2	55.42
G6	Salix caprea (Goat Willow)	SM	1	150	C2	6(2)	2	2	2	2	F	F	10+	small multstemmed goat willow scrub			1.8	10.18	
T1	Fraxinus excelsior (Ash)	M	1	450	C2	14(5)	4	4	5	4	F	F	10+	ash tree of fair form, twin stem			5.4	91.62	
T2	Acer platanoides (Norway Maple)	EM	1	400	B2	9(3)	5	5	5	6	G/F	G/F	20+	Ivy on tree. Surrounding vegetation prevented close inspection of the tree therefore all observations and measurements are estimated.	tree of fair form			4.8	72.39
T3	Carpinus betulus (Hornbeam)	EM	1	300	C2	7(2)	4	1	1	4	F	F	10+	Suppressed growth from surrounding trees.			3.6	40.72	

10.0 Appendix 1B – Detailed Tree Survey Data Summary

(Please see Appendix 3 - Tree Survey Key)

Field Usage Results.		
Total Records: 10		
Type	Count	% of Total
T	3	30
G	6	60
Tree Species	Count	% of Total
X Cupressocyparis leylandii (Leyland Cyp)	2	20
Prunus avium (Wild Cherry)	1	10
Fraxinus excelsior (Ash)	1	10
Salix caprea (Goat Willow)	1	10
Acer platanoides (Norway Maple)	1	10
Carpinus betulus (Hornbeam)	1	10
Average Stem Diameter	Count	% of Total
<50	1	10
<250	4	40
<500	5	50
Cat	Count	% of Total
B2	1	10
C2	8	80
Age	Count	% of Total
SM	2	20
EM	3	30
M	4	40
Height	Count	% of Total
<10	7	70
<15	2	20
Phy Cond	Count	% of Total
G/F	1	10
F	8	80

Stuc Cond	Count	% of Total
G/F	1	10
F	4	40
F/P	3	30
N/A	1	10
Est. Remain Contrib	Count	% of Total
10+	8	80
20+	1	10
RPR	Count	% of Total
<5	8	80
<10	2	20
RPA	Count	% of Total
<5	1	10
<15	3	30
<20	1	10
other	5	50

10.0 Appendix 2 - Tree Constraints Plan

An introduction to the Tree Constraints Plan (TCP)

Trees identified to be retained should be treated as constraints to the design of future development. A Tree Constraints Plan has been drawn and can be found over leaf.

- **Tree Quality** - The TCP highlights the above and below-ground constraints each tree poses to design future development schemes. Further, the BS5837 tree quality category (A - High, B - Moderate, C - Low and U- Unsuitable for retention) are coloured coded as solid circles at the centre of the tree's position.
- **Root Protection Area** – The magenta circle on the TCP sets out the root protection area (RPA). No construction work in this area, ground-level alteration or site traffic (machinery or persons) should occur. This prevents damage to tree roots and soil compaction. (Where possible, an Arboriculturist can design suitable tree protection methods to facilitate construction work/site traffic within these areas).
- **Tree Canopy** - The green circle/oval on the TCP sets out the above-ground constraints of tree canopy spread. Within this area, no construction work or site traffic (machinery or persons) should occur if the tree is to be retained. This prevents damage to the tree branches and trunk. (Where possible, an Arboriculturist can design suitable tree protection methods to facilitate construction work/site traffic within these areas).
- **Tree Shading** – Shade from the retained trees should be considered in the development design. Depending on the tree's height and width, the shade cast will be from a North West to East pattern through the central part of the day.
- **Tree Future growth** - Within future development design, consideration should also be given to the ultimate height and extent of the canopy spread of all trees within site identified to be retained.

- KEY BS5837:2012 Tree Quality (Colour Code)**
- Category A (High) ("Highly desirable for retention")
 - Category B (Moderate) ("Desirable for retention")
 - Category C (Low) ("Optional for retention")
 - Category U (Poor) ("Unsuitable for retention")

- Tree Key - Individual Trees**
- Tree ID# (Individual Tree)
 - Tree Species (Common Name)

Root Protection Area (RPA) (A layout design tool indicating the minimum area around a tree deemed to contain sufficient roots and rooting volume to maintain the tree's viability, and where the protection of the roots and soil structure is treated as a priority)

- Tree Key - Group/Area/Woodland/Hedge/row**
- Tree ID# (Group, Area, Woodland, Hedge, Row)
 - Tree Species (Common Name)

- BS5837:2012 Tree Quality (Colour Code) in Group**
- Average Branch Spread

- Shade Pattern - shade pattern not shown on plan** (any morning shade starting from the east through to evening shade to the east)

- Definitions of BS5837:2012 Categories for Trees, Woodlands and Hedge/rows (Colour Code):**
- A** - Those of high quality with an estimated remaining life expectancy of at least 40 years. ("Highly desirable for retention")
 - B** - Those of moderate quality with an estimated remaining life expectancy of at least 20 years. ("Desirable for retention")
 - C** - Those of low quality with an estimated remaining life expectancy of at least 10 years, or young trees with a stem diameter below 150mm. ("Optional for retention")
 - U** - Those in such a condition that they cannot realistically be retained as living trees in the context of the current land use for longer than 10 years. ("Unsuitable for retention unless provides high conservation value")

Please Note: Barriers and Ground Protection must be designed by an arboriculturist, installed before materials or machinery is brought onto site and before any demolition, development or stripping of soil commences. Once erected, barriers and ground protection should be regarded as sacrosanct, and should not be removed or altered without prior recommendation by an Arboriculturist and approval of the Local Planning Authority (LPA).



small suppressed in form scattered hawthorn in poor condition

G2-Ash, Norway Maple

G3-Wild Cherry

G3-Wild Cherry

G3-Wild Cherry

G1-Leyland Cyp

G5-Sycamore Ash

G6-Goat Willow

G4-Leyland Cyp

T2-Norway Maple

T3-Hornbeam

T1-Ash

- Category A (High) - Highly desirable for retention
- Category B (Moderate) - Desirable for retention
- Category C (Low) - Optional for retention
- Category U (Poor) - Unsuitable for retention

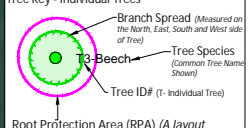

Root Protection Area (RPA) (A layout design tool indicating the minimum area around a tree deemed to contain sufficient roots and rooting volume to maintain the tree's stability, and where the protection of the roots and soil structure is treated as a priority)

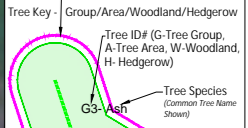

Definitions of BS5837:2012 Categories for Trees, Woodlands and Hedge/rows (Colour Code)

- A - Those of high quality with an estimated remaining life expectancy of at least 40 years. ("Highly desirable for retention")
- B - Those of moderate quality with an estimated remaining life expectancy of at least 20 years. ("Desirable for retention")
- C - Those of low quality with an estimated remaining life expectancy of at least 10 years, or young trees with a stem diameter below 150mm. ("Optional for retention")
- U - Those in such a condition that they cannot realistically be retained as living trees in the context of the current land use for longer than 10 years. ("Unsuitable for retention unless provides high conservation value")

Please Note: Barriers and Ground Protection must be designed by an arboriculturist, installed before materials or machinery is brought onto site and before any demolition, development or stripping of soil commences. Once erected, barriers and ground protection should be regarded as sacrosanct, and should not be removed or altered without prior recommendation by an Arboriculturist and approval of the Local Planning Authority (LPA).



10.0 Appendix 3 - Tree Survey Data Key

- **Tree ID #** - Identifies the location of individual trees (T-ID Number), Groups of trees (G-ID Number), Area of trees (A-ID Number), Hedgerow (H-ID Number), Woodland (W-ID Number), Row of trees (R-ID Number) and tree Stumps (S-ID Number) on the accompanying plan. *(Please note: A group of trees here refers to two or more standing trees that form a visual whole, whereas an area of trees refers to dispersed individual trees standing within the site)*
- **Tree Species** - Scientific names and common tree name in brackets are generally shown.
- **Age**
 - (Y) Young – Less than 1/3 of life completed
 - (SM) Middle Aged - 1/3 - 2/3 of life completed
 - (EM) Early Mature – Just entering Maturity
 - (M) Mature – more than 2/3 of life completed
 - (OM) Over Mature - more than 3/3 of life completed and declining
 - (V) Veteran - (v) Veteran – Veteran trees have no precise definition but are trees considered to be of biological aesthetic or ecological value because of their age
- **Stems** – Number of tree stems used to calculate the RPR/RPA
- **Stem Diam** (mm) - Diameter of tree stem measured in millimetres for single stem trees or average stem diameter calculated for multi-stemmed trees as detailed in section 4.6 & Annex C of the British Standard 5837:2012, Trees in relation to design, demolition and construction - Recommendations. The height above ground level where the stem measurement was taken will be shown if not measured at 1.5 metres above ground level. *(Please note: that the stem diameter of certain trees will have to be estimated due to difficulties in taking measurements or for trees with a large number of stems)*
- **Cat** – Tree Quality Category - British Standard 5837:2012 A, B, C, U + 1, 2, 3

Based on BS5837:2012, categories A, B, C, and U provide the basis for prioritising trees for retention:

- A – Those of high quality with an estimated remaining life expectancy of at least 40 years. (*Most desirable for retention*)
- B - Those of moderate quality with an estimated remaining life expectancy of at least 20 years. (*Desirable for retention*)
- C – Those of low quality with an estimated remaining life expectancy of at least 10 years, or young trees with a stem diameter below 150mm. (*Optional for retention*)
- U – Those in such a condition that they cannot realistically be retained as living trees in the context of the current land use for longer than 10 years. (*Unsuitable for retention unless provides high conservation value*)

Retention Criteria Subcategories: Used for identifying subcategories

E.g. A2 = A high-quality tree with high landscape qualities (further details can be found in British Standard 5837:2012, Trees in relation to design, demolition and construction - Recommendations UK; British Standards Intuition)

- o 1 – Mainly Arboricultural qualities
- o 2 – Mainly landscape qualities
- o 3 – Mainly cultural values, including conservation

- **Height + (Lower Branch Height)** - Tree height in metres and in brackets height in metres of the crown (tree branches) clearance at its lowest point above adjacent ground levels.

- **Nrth, Est, Sth, Wst** - Crown Spread (Metres) -Tree branch spread in metres measured in four directions (North, East, South, West) from the trunk.

- **Phys Cond** - Physiological Condition Indicating the health of the tree -
 - o (G) Good
 - o (F) Fair
 - o (P) Poor
 - o (D) Dead

- **Struc Cond** – Structural Condition indicating the structural integrity of the tree -
 - o (G) Good – No, or remediable physical defects or decay
 - o (F) Fair - Physical non-remediable defects or decay present, not presenting imminent danger but should be monitored
 - o (P) Poor - physical non-remediable defects or decay present, tree liable to imminent collapse or loss of major limbs.
 - o (D) Dead

- **Est. Remain Contrib - (<10, 10+, 20+, 40+)**

The trees estimated remaining contribution in years, recorded as:

 - o <10 – less than 10 years
 - o 10+ – at least 10 years
 - o 20+ – at least 20 years
 - o 40+ – at least 40 years

- **Comments** – Additional Comments, if required

- **Preliminary Management Recommendations** – Work Recommendations, including further investigation of suspected defects that require more detailed assessment and pose potential for wildlife habitat.

- **Work Priority** - Work Priority -This gives a work priority rating of preliminary management for each tree.
 - H - High – Urgent work to be carried out as soon as practicable due to safety reasons (Within 14 days).
 - H/M – High - Medium – Work to be carried out within 6 months/or before the construction phase begins
 - M - Medium – Work to be carried out in 12 months
 - L - Low – After consideration/Re-inspect in 18-24 months
 - Blank – No work required.

- **RPR** – Root protection radius / **RPA** - Root Protection Area - Is a layout design tool indicating the minimum area around a tree deemed to contain sufficient roots and rooting volume to maintain the tree's viability and where the protection of the roots and soil structure is treated as a priority. RPR is a circular area measured as a radius in metres from the tree's centre, or RPA is an area in metres squared. This area may be changed in shape but not reduced in size, providing adequate protection for the tree's rooting system.

10.0 Appendix 4 – Tree Protection Plan

Tree Protective Fencing

- Trees for removal to be identified from the drawing and marked by an arboriculturist.
- No vehicles to enter the grass verge or root protection zone during tree removal or fencing installation/removal.
- Fencing to be installed prior to any construction works (including demolition, materials delivery, works compound installation).
- The location of the tree protective fencing is indicative only and must not be directly measured from this plan. Its true location must be surveyed accurately on site and where applicable be measured from the tree centre by the stated dimension works.
- Fencing to remain in place until all construction works have ceased.

BS5837: 2012 Recommendations (extract)

6.2.2.3 Where the site circumstances and associated risk of damaging incursion into the RPA do not necessitate the default level of protection, an alternative specification should be prepared by the project arboriculturist and, where relevant, agreed with the local planning authority.

Fencing Specification

For example: 2metre tall welded mesh panels on rubber or concrete feet might provide an adequate level of protection from cars, vans, pedestrians and manually operated plant. In such cases, the fence panels should be joined together using a minimum of two anti-tamper couplers, installed so that they can only be removed from inside the fence. The distance between the fence couplers should be at least 1 m and should be uniform throughout the fence. The panels should be supported on the inner side by stabilizer struts, which should normally be attached to a base plate secured with ground pins. Where the fencing is to be erected on retained hard surfacing or it is otherwise unfeasible to use ground pins, e.g. due to the presence of underground services, the stabilizer struts should be mounted on a block tray. (See Diagram Below)

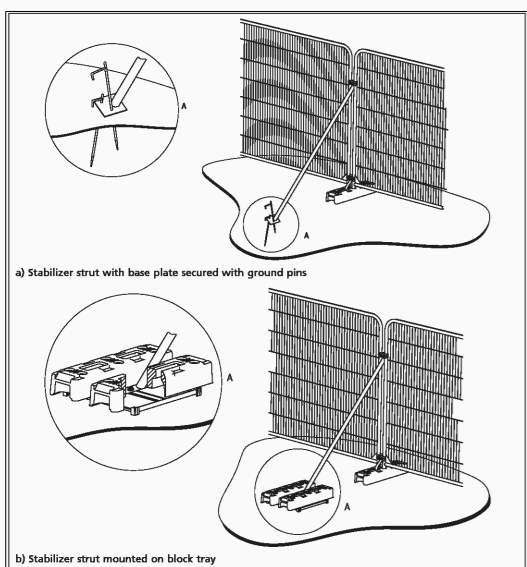

Why Is Fencing Erected Around Trees?

- The major cause of damage to trees on construction sites is due to soil compaction.
- Roots use the spaces between soil particles to obtain Oxygen, Water and Nutrients.
- Heavy plant and machinery compresses (compacts) the soil, squashing out the air spaces and preventing root function.
- A compacted soil structure will stay compacted.
- Consequently the tree suffers and will show signs of branch die-back.
- Symptoms such as die-back may take several years to appear.
- Soil compaction over roots can be prevented by maintaining a fenced exclusion zone over the tree roots.
- The exclusion zone is calculated using British Standard 5837.
- Protective Fencing is installed around the calculated area.
- Protective Fencing is a condition of planning approval. If it is removed or repositioned the construction firm is in breach of a condition and may be subjected to legal action.

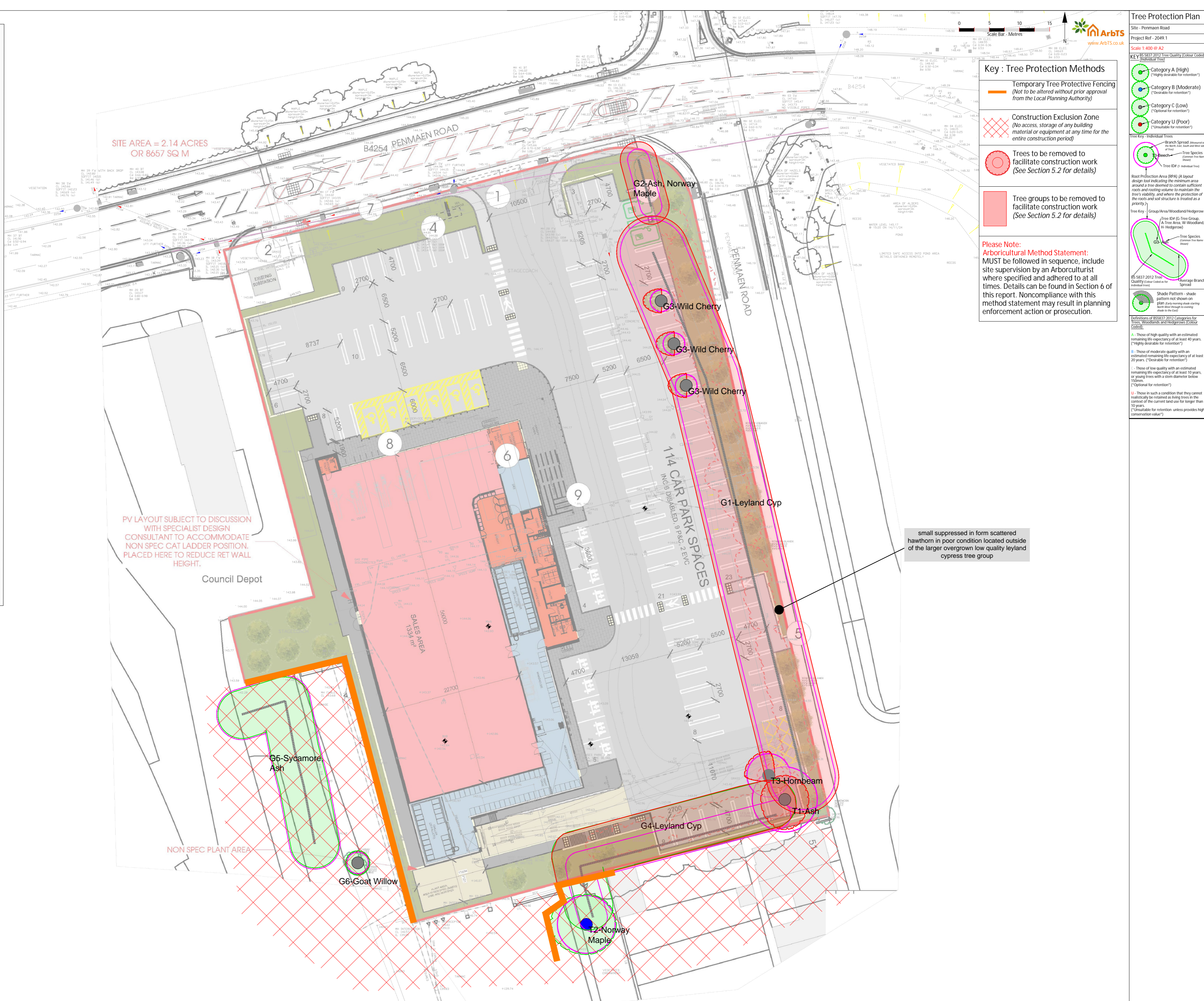

Key : Tree Protection Methods

- Temporary Tree Protective Fencing (Not to be altered without prior approval from the Local Planning Authority)
- Construction Exclusion Zone (No access, storage of any building material or equipment at any time for the entire construction period)
- Trees to be removed to facilitate construction work (See Section 5.2 for details)
- Tree groups to be removed to facilitate construction work (See Section 5.2 for details)

Please Note: Arboricultural Method Statement: MUST be followed in sequence, include site supervision by an Arboriculturist where specified and adhered to at all times. Details can be found in Section 6 of this report. Noncompliance with this method statement may result in planning enforcement action or prosecution.

Tree Protection Plan

Site - Penmaen Road
Project Ref - 2049.1
Scale 1:400 @ A2

KEY BS5837:2012 Tree Quality (Colour Code)

- Category A (High) - (Highly desirable for retention)
- Category B (Moderate) - (Desirable for retention)
- Category C (Low) - (Optional for retention)
- Category U (Poor) - (Unsuitable for retention)

Tree Key - Individual Trees

- Branch Spread - Assumed as the branch length from the trunk
- Tree Species - Common Tree Name (Over)
- Tree ID# (Individual Tree)

Root Protection Area (RPA) (A layout design tool indicating the minimum area around a tree deemed to contain sufficient roots and rooting volume to maintain the tree's stability, and where the protection of the roots and soil structure is treated as a priority)

Tree Key - Group/Area/Woodland/Hedge/row

- Tree ID# (G-Tree Group, A-Tree Area, W-Woodland, H-Hedge/row)
- Tree Species - Common Tree Name (Over)
- Average Branch Spread

BS5837:2012 Tree Quality (Colour Code)

- Shade Pattern - shade pattern not shown on plan daily moving mask starting from the trunk through to canopy shade to the face

Definitions of BS5837:2012 Categories for Trees, Woodlands and Hedge/rows (Colour code):

- A - Those of high quality with an estimated remaining life expectancy of at least 40 years. (*Highly desirable for retention)
- B - Those of moderate quality with an estimated remaining life expectancy of at least 20 years. (*Desirable for retention)
- C - Those of low quality with an estimated remaining life expectancy of at least 10 years, or young trees with a stem diameter below 150mm. (*Optional for retention)
- U - Those in such a condition that they cannot realistically be retained as living trees in the context of the current land use for longer than 10 years. (*Unsuitable for retention unless provides high conservation value)

10.0 Appendix 5 – Tree Photographs

Tree ID#G1



Tree ID#G1



Tree ID#G1



Tree ID#T3 + T1



Tree ID#G4



Tree ID#G5 + G6



Tree ID#T2



Tree ID#T1



