

**LIDL : PENMAEN ROAD
PONTLLANFRAITH
NP12 2DY**

GREEN INFRASTRUCTURE STATEMENT



24 February 2025

Corcadden Associates
77 Fairleigh Road
Cardiff
CF11 9JW
07966 423074

ca@corcaddenassociates.com

GREEN INFRASTRUCTURE STATEMENT

LIDL STORE : PONTYMISTER : RISCA. NP11 6EE

1.0 INTRODUCTION

This is the Green Infrastructure Statement for the proposed Lidl store and associated carpark. The Site is part of the previous Stagecoach Bus Depot I Penmaen Industrial Estate. The B4254 lies to the north of the Site, a Council Yard to the east, a section of the bus depot and a linear section of terraced houses to the south and a dead end section of Penmaen Road and adjacent attenuation pond with a woodland surround. It has a postal code NP12 2DY and grid reference ST 180964 and is referred to as the 'Site' in this document.

2.0 TERMS

The definition of Green Infrastructure in Chapter 6 of Planning Policy Wales 12 February 2024 is

'Green infrastructure is the network of natural and semi-natural features, green spaces, rivers and lakes that intersperse and connect places. Component elements of green infrastructure can function at different scales and some components, such as trees and woodland, are often universally present and function at all levels. At the landscape scale green infrastructure can comprise entire ecosystems such as wetlands, waterways peatlands and mountain ranges or be connected networks of mosaic habitats, including grasslands. At a local scale, it might comprise parks, fields, public rights of way, allotments, cemeteries and gardens or may be designed or managed features such as sustainable drainage systems.. At smaller scales, individual urban interventions such as street trees, hedgerows, roadside verges, and green roofs/walls can all contribute to green infrastructure networks.'

The Environment (Wales) Act 2016 provides a context for the delivery of multi-functional green infrastructure. Its provision can make a significant contribution to the sustainable management of natural resources. Green infrastructure is capable of providing several functions at the same time and as a result offers multiple benefits, for social, economic and cultural as well as environmental resilience and respond to challenges presented by the climate emergency.

A Step Wise Approach is required to be demonstrated in the Green Infrastructure Statement.

To assess impacts on habitats and species

Step 1 Avoid

Step 2 Minimise

Step 3 Mitigate/Restore

Step 4 Compensate on Site

Step 4 Compensate Off-Site

Steps 1-4 Using the DECCA Framework for all relevant steps that require enhancement

Step 5 Long Term Management Plan

These steps will indicate how Net-Benefit-for-Biodiversity is achieved.

Without an achievement Step 6 would result in a refusal for a development.

Mitigation' to mean 'measures taken to avoid or reduce negative impacts', as separate from 'compensation' meaning 'measures taken to make up for the loss of, or permanent damage to, biological resources through the provision of replacement areas'

3.0 DOCUMENTS

Refer to the following documents as reference for the statement

- CA 2025-BKWD-01 Lidl Pontllanfraith Existing Features
- CA 2025-BKWD-02 Rev A Landscape Existing Features and Overlay
- CA 2025-BKWD-03 Rev B Landscape Proposals Overall
- CA 2025-BKWD-04 Rev A Lidl Pontllanfraith Landscape Proposals Trees-Hedges-Native

- CA 2025-BKWD-05 Rev A Lidl Pontllanfraith Landscape Proposals Planting Beds
- CA 2025-BKWD-06 Lidl Pontllanfraith Landscape Sections
- CA 2025-BKWD-07 Lidl Pontllanfraith Green Infrastructure
- CA Lidl Pontllanfraith Planting Schedule Rev19February2025
- CA Lidl Pontllanfraith Planting Methodology and 5 Year Aftercare rev19February2025.
- Arboricultural Report Land at Pontllanfraith (ArbTS 4 Feb 2025)
- Preliminary Ecological Appraisal (Lucion February 2025)
- 2973 P403D General Setting Out Plan.

4.0 EXISTING SITE DETAIL

The existing Site area is 8657m² (0.8657Hectares) and 2.14Acres. It is roughly rectangular and is currently part of a bus depot. The northern half of the Site has banked grass frontage with an existing substation and limited access from B4254 to the side of large building that extends to the west boundary. The east boundary with Penmaen Road is mainly a Leyland Cypress line with Norway Maple and Ash at the B4254 end and Hornbeam and Ash at the end by No 51 with a few cherry trees on the Site side of the line a scattered hawthorn trees in the grass verge facing Penmaen Road .

The building has a side section jutting out from the western boundary into the Council Yard and north of this jutting out section is the Council Depot building.

The lower section of the Site slopes to south and is a hard surface yard with a fenced boundary to the Council Yard on the west but the actual Site boundary line is inset from this fence. To the east is the Leyland Cypress line. To the south is a continuation of the bus depot area and a Leyland Cypress line screening along the rear garden line of No 51.

The bus depot land is a roughly triangular area consisting of washery area and a general area with access to the industrial estate roads. A Leyland Cypress line on the east boundary screening the terraced housing line.

Internally the Site has a variety of hard surfacing sealed and unsealed and covered with stored materials and no scrub or trees.

4.1 EXISTING SITE SUMMARY

The existing site is in two different parts

- Northern section with an existing building with a grassed frontage an eastern Leyland Cypress line.
- Southern hard surfaced area with jutting out old building and open boundary to the west and open section a Leyland Cypress line to the south.

The existing vegetation is on Site

- Rough grass banked frontage area with B4254
- Leyland Cypress line on east and part of west boundary with a few associated trees.
- Rough grass and scrub by the southern Leyland Cypress line.

5.0 TREES

The BS : 5837 tree quality category (A - High, B - Moderate, C - Low and U- Unsuitable for retention) and the Site has mainly C low value trees with only 1No B moderate value tree.

The survey includes trees both on and off Site

The trees off-Site are all C2 category except the T2 Norway Maple which is B2

- T2 Norway Maple and small section of G4 Leyland Cypress line
- G6 Goat Willow
- G5 Sycamore and Ash

These are not impacted by the Site proposals apart from cutting back the conifer line to the southern Site boundary.

All the other Site trees are to be removed and all are C2 category

- T1 Ash
- T3 Hornbeam
- G1 Leyland Cypress line
- G2 Ash and Norway Maple
- G3 Cherry trees
- G4 Leyland Cypress line screen in rear garden of No 51 on the southern boundary.

5.1 TREE SUMMARY

In summary there are 6No Tree group (of which 2No are Leyland Cypress lines) and 3No trees surveyed.

- Off Site trees 1No Tree and 2no groups retained nom impact by development.
- On Site 2No individual trees and scattered Hawthorns in the verge removed
- On Site 3No Tree groups and 2no Leyland Cypress trees removed.

AVOIDANCE MEASURES

- Tree felling to be undertaken outside the bird nesting season unless checked by a suitably qualified Ecologist and approval given to proceed.
- Tree protection measures to retained section of Leyland Cypress just off-site by the corner of No 51 rear garden.

Adhering to the details in the Arboricultural Report and there will be compensation for tree loss. The proposed development can be constructed without any impact on the retained trees and groups off Site.

COMPENSATION/ENHANCEMENT

Compensation is proposed to address the impacts on habitats which cannot be avoided or mitigated:

- Tree and hedgerow losses to facilitate the development are to be compensated by new plantings with 33No trees mainly native , hedge 25linear metres and native blocks 525 square metres.

6.0 ECOLOGY

6.1 HABITATS

The Preliminary Ecological Assessment (PEA) notes there are no priority habitats on Site and the following habitats on Site are :-

- Modified grass land
- Bare ground
- Individual trees
- Leyland Cypress lines
- Developed land/sealed surfaces
- Two Utility Buildings

6.2 PROTECTED AND PRIORITY SPECIES

The protected species which may occur on site are`

- Great Crested Newt
 - Due to lack of connectivity to suitable breeding habitats this species is considered to be absent from the Site.
- Bats
 - Negligible roosting potential and limited foraging potential
 - Site considered as low value to bats.
- Birds
 - Overall, the Site is considered to be of local value for birds and further surveys are not recommended. A precautionary approach to safeguard birds during construction, together with post development compensation measures, is recommended.
- Reptiles

- A reptile check was not conducted during the walkover, however the on-Site habitats were of negligible suitability to support reptiles. The Site was also separated and fragmented from suitable off-Site habitat by buildings/roads.
- Hedgehog
 - The Site has the potential to support the priority species hedgehog, with habitats providing some limited suitability for foraging and resting. However, no evidence of this species was found at the time of survey.
- Badgers and Dormice
 - Site unable to support badgers or dormice
- Priority Species
 - The site has the potential to support the priority species of hedgehogs.

6.3 INVASIVE NON-NATIVE SPECIES

Invasive non-native species (INNS) none noted on Site.

6.4 ECOLOGY SUMMARY

AVOIDANCE

The following measures should be incorporated into the design of the development, including the construction phase, to avoid and reduce impacts on wildlife:

- Retained trees and retained Leyland Cypress hedge section and root spreads of off-site trees extending into the Site to be protected.
- Avoid site clearance works during the nesting bird season (March to August inclusive) unless the site is checked by a Suitably Qualified Ecologist (SQE) and active nests are confirmed to be absent no later than 48 hours before works commence.
- External lighting will be designed in line with BCT Guidance 8 to reduce the impacts on bats and range of other wildlife associated with retained and off-site habitats.
- All construction activities will be programmed to daytime hours to reduce disturbance to sensitive nocturnal species, such as bats and roosting bird species.

MITIGATION

Mitigation is proposed to reduce the impacts on wildlife that cannot be avoided through design:

- All works will be undertaken in accordance with a CEMP (Construction Ecological Management Plan). Ecological receptors likely to be covered in this plan will include, but not be limited to hedgehog, birds and reptiles.
- Excavations should be securely covered or fenced overnight, or otherwise provide a means of escape for animals that may become trapped in the form of a ramp at least 300mm wide and angled no greater than 45°. Excavations should be inspected for the presence of animals before work recommences and, in the event of trapped animals being trapped, an ecologist contacted for advice.
- Gaps of at least 13cm x 13cm will be created within boundaries to facilitate movement of hedgehogs and other small animals through the Site.

COMPENSATION/ENHANCEMENT

Compensation is proposed to address the impacts on habitats which cannot be avoided or mitigated:

- The incorporation sparrow terrace bird boxes attached to the store building.
- Boundaries are all planted with trees and native blocks on the west boundary and part of south boundary. An ornamental evergreen pollinator hedge on south boundary by No 51 rear garden. Ornamental beds occur of east and northern boundaries. The boundary planting is to give connectivity.
- Trees predominately native combined with native shrubs, hedges and pollinator ornamentals are the main biodiversity type for the site. Berrying and fruit-bearing species alongside pollinator species, to provide increased foraging opportunities in the local area.

6.5 DECCA FRAMEWORK DIVERSITY

- Genetic and species diversity increased through habitat creation, enhancement and management to promote a greater diversity and number of fauna and flora species using the Site.
- The existing Site had low diversity and the proposed trees and native blocks will increase structural diversity of habitats which will be maintained through habitat enhancement and management.

EXTENT

- The extent of tree, native block and ornamental planting beds within the Site is increased by the proposed planting and their management.

CONDITION

- Habitat condition will be improved through habitat creation and enhancement and management.

CONNECTIVITY

- Connectivity within the Site will be increased through creation and enhancement of linear boundary habitats
- Connectivity in the wider landscape will be improved through links to the linear vegetation of B4254 and fragmented vegetation of B4251.

ASPECTS OF ECOSYSTEM RESILIENCE

- Recovery of ecosystems will be improved through an increase in the diversity of habitats and increased connectivity and management.

7.0 DRAINAGE AND BUILDING

- The proposed Site will have hard surfaces with gullies and drains the proposed scheme will ensure water pollution into the adjacent River Sirhowy will be avoided.
- The Building is designed to have photovoltaics on the roof to reduce the required power input from the grid for the operation of the store.

AVOIDANCE

- Avoid pollution to nearby watercourses and dust to adjacent areas.
- Ensure drainage system avoids pollution into nearby River Sirhowy.

8.0 SITE SETTING

The Site and designated areas or within the Site or 2 Kilometres are as follows:

DESIGNATIONS

- National Landscape Character Area NCLA37 South Wales Valleys.
Within the South Wales Valley Character is extensive ribbon developments filling many valley bottoms and lower slopes. Their urban and industrial character is juxtaposed with dramatic upland settings with steep hillsides, open moors or forests. Networks of railways and roads connect valley settlements. Topography constrains passage between valleys, and there are only a limited number of high passes between valleys. The noise and business of many valleys contrast with the relatively remote and wild qualities of adjacent hill plateaux. Yet today a new image is gradually but fundamentally changing the old one. Modern road improvements and bypasses bristle with street lighting, spreading the urban influence beyond the old settlement envelopes and altering the character experienced when travelling.
IMPACT LOW.
- SSSI (site of Special Scientific Interest) and LNR (Local Nature Reserve) Memorial Park Meadows Nature Reserve. 260m West. Unimproved grassland. NEGLIGIBLE IMPACT WITH AVOIDANCE MEASURES DUE TO SITE PROXIMITY.
- SSSI Penllwyn Grasslands. 1.15Km West. A mosaic of habitats including wet acid grassland, woodland, scrub and tall herb vegetation. It has an extensive area of species-rich moor grass *Molinia*. NO IMPACT

- SINC Enterprise Way Grassland. 100m East. Broadleaved woodland and marshy and neutral grassland. NEGLIGIBLE IMPACT WITH AVOIDANCE MEASURES DUE TO SITE PROXIMITY.
- SINC River Sirhowy 180m West. River fish and bank vegetation. NEGLIGIBLE IMPACT WITH AVOIDANCE MEASURES DUE TO SITE PROXIMITY.
- SINC Galn-Brynar Woodlands, Pentwynmawr. 220m East. A mix of habitats including three small broad-leaved woodlands, three small fields of damp neutral / marshy grassland, a small area of semiimproved acid grassland and a disused railway-line. NEGLIGIBLE IMPACT WITH AVOIDANCE MEASURES DUE TO SITE PROXIMITY.
- SINC Penmaen Carr, East of Blackwood. 460m North. The site has important commuting opportunities for bats with woodland having potential to support both bats and dormice. LOW IMPACT
- SINC Penllwyn Woodland. 490m Southwest. semi-natural broadleaved woodland; the northwestern corner being of ancient origin. Potential for butterfly and moths.
- SINC Blackwood Riverside Woodlands. 660m North. An almost unbroken belt of woodland and scrub extending for over 2km along the Sirhowy River valley.

URBAN SETTING

The Site is either within or connected or outside and not connected to any of the following:

- It is within an industrial estate within a mixed area of residential, commercial and industrial
- No connections to any National Cycle Route
- The open spaces close to the Site are:
 - Council Offices Grounds
 - Memorial Park Meadows Nature Reserve
 - Small parks and open space around Penmaen Rd residential area
 - Industrial estate road with section of Sirhowy Valley Walk where it cannot follow river edge.
 - Road with footpaths linking to football ground and associated pitches to the north of the Site near railway line.
- Public Rights of Way
 - There is no public right of way through the Site.
 - There are footpaths associated with B4254 which directly access the Site. The pedestrian crossing island on the B4254 is proposed to be extended and a second island added to facilitate those walking to/from the west. There is footpath to Penmaen Road which will give a pedestrian access during the development.
 - The Sirhowy Valley Walk goes through the industrial estate and development only gives access indirectly along B4254.

GREEN AND BLUE INFRASTRUCTURE

The Site is part of a Green Blue Infrastructure in an urban area.

The Blue Infrastructure is the River Sirhowy and the number of streams flowing into the river from the Council Offices land. The Site only connects with it indirectly via the vegetation links of B4254 and fragmented vegetation of B4251.

The proposed development also creates new and enhanced local habitats with the increase species diversity.

9.0 LONG TERM MANAGEMENT

The site will have a Planting Methodology 5 Year Landscape Management Plan which will include landscape annual inspections and reports to assess the establishment of the landscape and undertake defects replacements in this period and will be copied to the ecologist. The ecologist will undertake monitoring inspections in years 1 and 5 additional visits if annual reports raise issues. Revisions to the management plan will be made as necessary to assist successful establishment.

10.0 SUMMARY OF SITE AND NET BIODIVERSITY GAIN.

Tree and Leyland Cypress and frontage grass area and small areas of scrub rough grass losses to facilitate the development are to be compensated by new plantings with 33No trees mainly native , hedge 25linear metres, native blocks 525 square metres and planting beds 723 square metres. The proposed site will provide an improvement in connectivity by planting on all boundaries. which link to off-site vegetation to the north and east along the B4254 and Penmaen Road.

The Statement undertakes the Step system showing the Avoidance and Mitigation measures undertaken, Compensation made on Site. Long term management for the successful landscape establishment will ensure biodiversity objectives are met.

Overall the proposals, considering the location of the Site in this area of Pontllanraith and the Site's current low ecological value with limited diversity, will provide a biodiversity net gain.

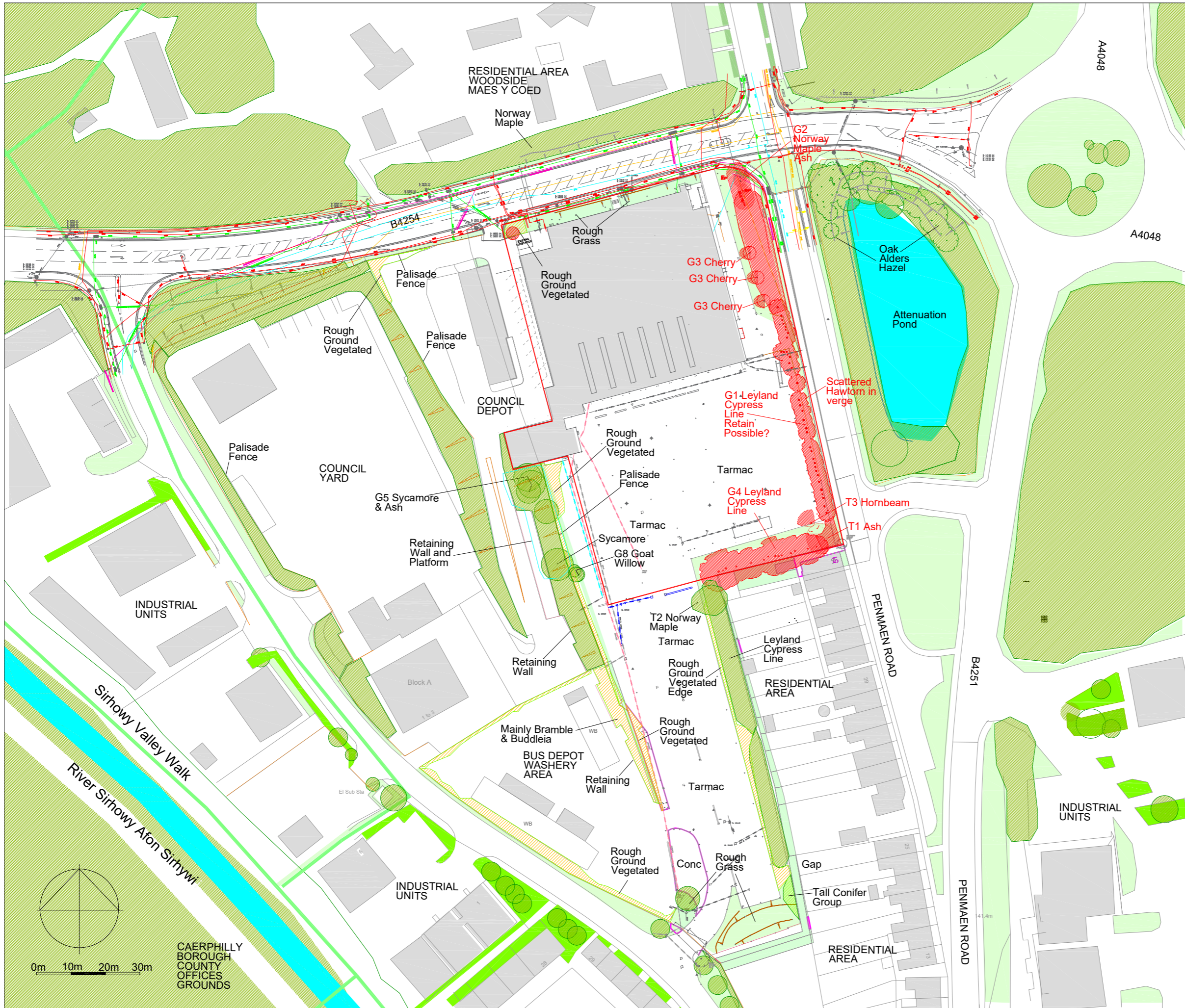

Legend

- Vegetation to be Removed
- Existing Trees and Vegetation
- Rough Ground Vegetated
- Grass Areas
- Bank/Contours
- River Pond
- Fence
- Application Boundary
- Public Rights of Way

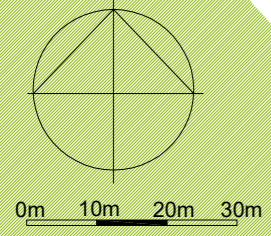

CAERPHILLY
BOROUGH
COUNTY
OFFICES
GROUNDS

Corscadden Associates
77 Fairleigh Road
Cardiff. CF11 9JW
Tel 07966 423074
email ca@corscaddenassociates.com

Project
**PENMAEN ROAD
PONTLLANFRAITH
NP12 2DY**

Drawing Title
EXISTING FEATURES

Scale 1:750 at A2 Date 29 January 2025

Drawing No
173 CA-2025-BKWD-01

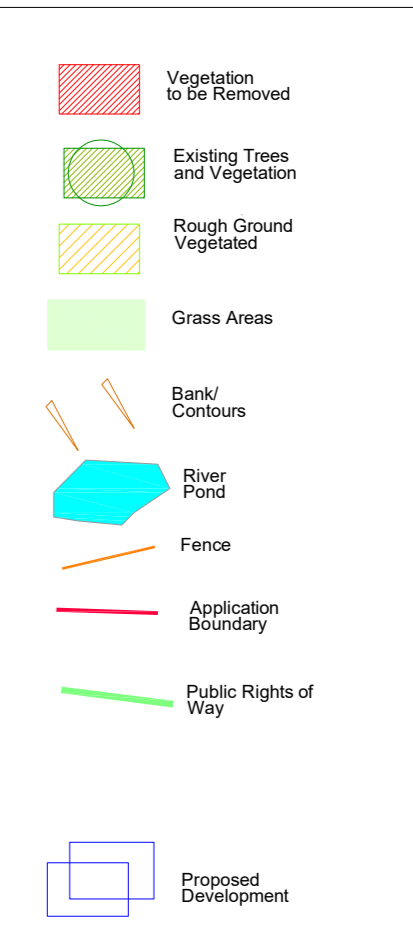
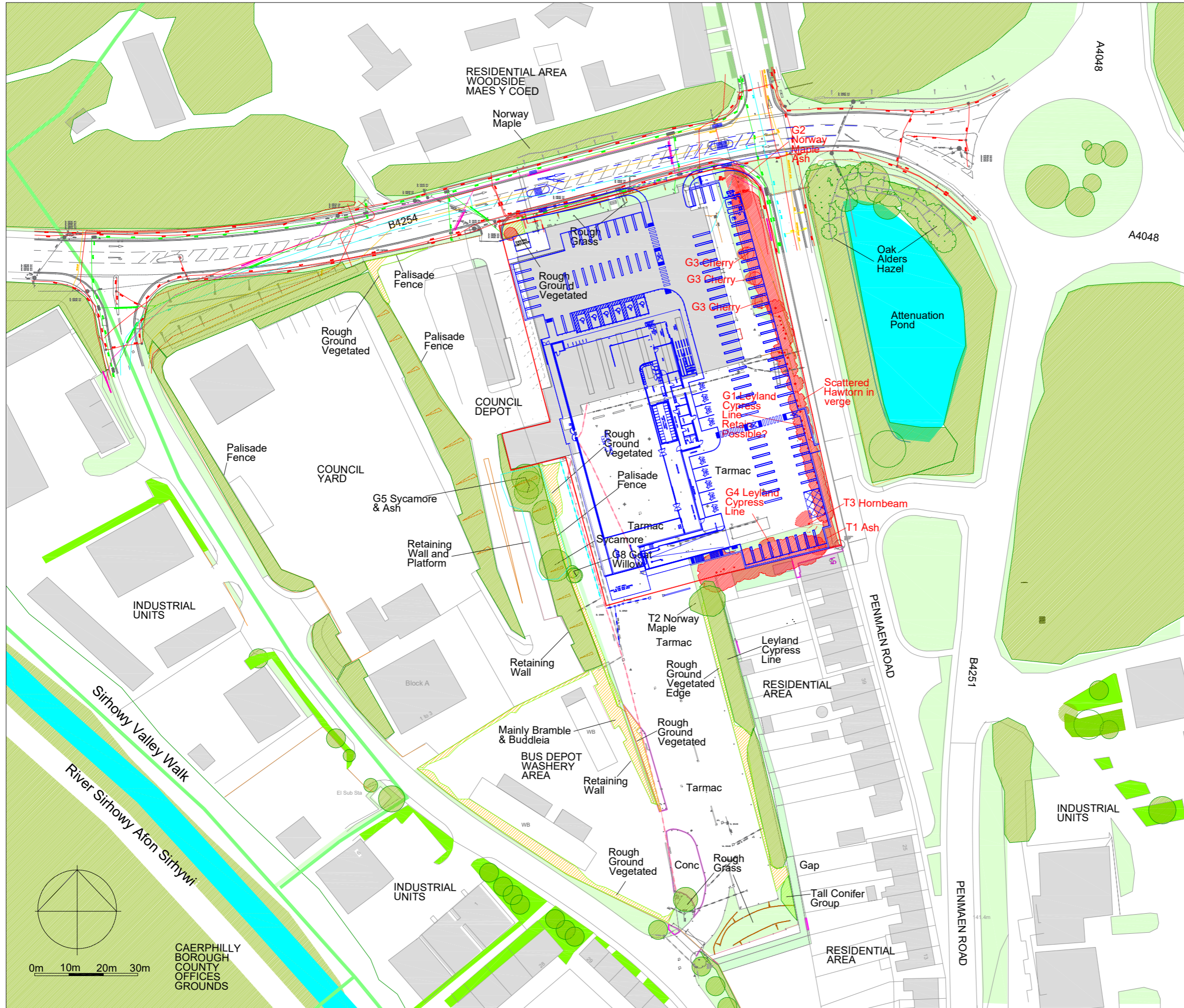

CA-2024- BKWD-02 Rev A
 29 Jan 2025
 Revised Layout

Corscadden Associates
 77 Fairleigh Road
 Cardiff, CF11 9JW
 Tel 07966 423074
 email ca@corscaddenassociates.com

Project
**PENMAEN ROAD
 PONTLLANFRAITH
 NP12 2DY**
 Drawing Title
**EXISTING FEATURES
 AND OVERLAY**

Scale 1:750 at A2 Date 29 Januaryr 2025

Drawing No
173 CA-2025-BKWD-02 Rev A

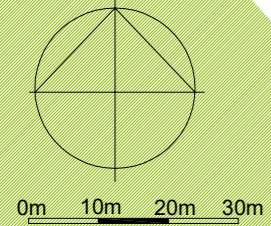

CAERPHILLY
 BOROUGH
 COUNTY
 OFFICES
 GROUNDS

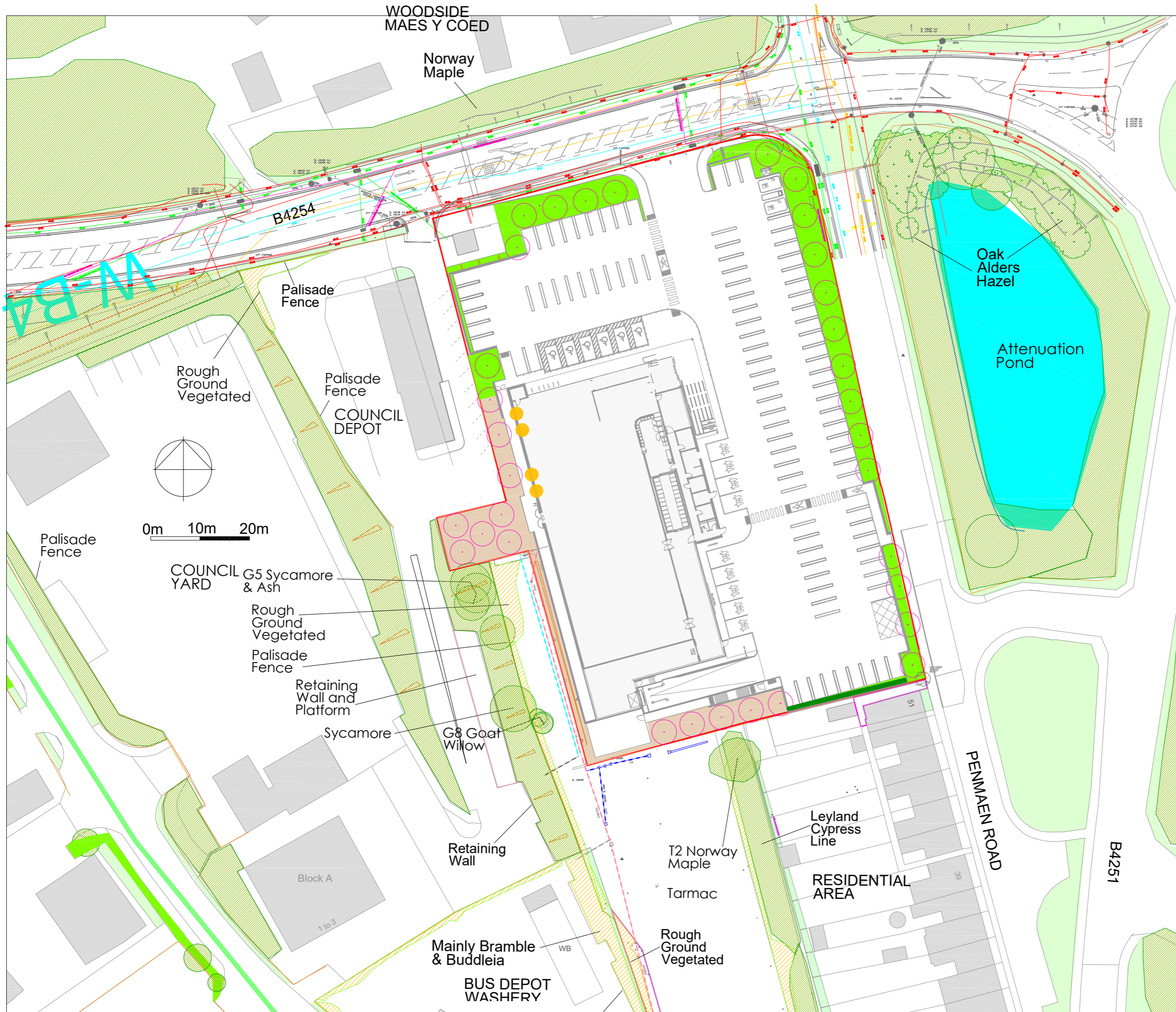

- Existing Trees and Vegetation
- Grass Areas
- Bank/Contours
- Fence
- Application Boundary
- Proposed Tree Planting
- Proposed Hedge
- Proposed Planting Beds
- Proposed Native blocks
- Sparrow Terrace

In accordance with Ecologist's recommendations

CA-2025- BKWD-03 Rev A
 14 Feb2025
 Revised layout

CA-2025- BKWD-03 Rev B
 18 Feb2025
 Bird boxes added

Corscadden Associates
 77 Fairleigh Road
 Cardiff, CF11 9JW
 Tel 07966 423074
 email ca@corscaddenassociates.com

Project
**PENMAEN ROAD
 PONTLLANFRAITH
 NP12 2DY**

Drawing Title
**LANDSCAPE
 PROPOSALS OVERALL**

Scale
 1:500 at A2

Date
 30 January 2025

Drawing No
173 CA-2025- BKWD-03 Rev B

RESIDENTIAL AREA
WOODSIDE
MAES Y COED

Norway Maple

B4254

Palisade Fence

Palisade Fence

COUNCIL DEPOT

Rough Ground Vegetated

COUNCIL YARD
G5 Sycamore & Ash

Rough Ground Vegetated

Palisade Fence

Retaining Wall and Platform

Sycamore

G8 Goat Willow

Retaining Wall

T2 Norway Maple

Tarmac

RESIDENTIAL AREA

Leyland Cypress Line

PENMAEN ROAD

B4251

Oak
Alders
Hazel

Attenuation Pond

Proposed Hedge

Proposed Planting Beds

Proposed Native blocks

Sparrow Terrace Bird Box

Existing Trees and Vegetation

Grass Areas

Bank/Contours

Fence

Application Boundary

Proposed Tree Planting

LIDL STORE - PENMAEN ROAD : PONTLLANFRAITH				15-Feb-25 rev 17 Feb 2025		
TREE PLANTING						
KEY	SPECIES	Native	Polimerfor	NAME	SIZE	QTY
All trees to be rootballed for autumn planting/winter planting only						
All Tree pits 1500 x 1500mm square as indicated						
AcE EXH	Acer campestre Elsrijk	N	P	Field Maple	14-16cm girth Extra Heavy Standard	3 No
ApEQ EXH	Acer platanoides Emerald Queen	N	P	Norway Maple	14-16cm girth Extra Heavy Standard	5 No
Ag EXH	Alnus glutinosa	N	P	Alder	14-16cm girth Extra Heavy Standard	2 No
Bpub EXH	Betula pubescens	N	P	Downy Birch	14-16cm girth Extra Heavy Standard	3 No
Bp EXH	Betula pendula	N	P	Silver Birch	14-16cm girth Extra Heavy Standard	1 No
Cbl EXH	Carpinus betulus Lucas	N	P	Hornbeam	14-16cm girth Extra Heavy Standard	9 No
Ms EXH	Malus sylvestris	N	P	Crab Apple	14-16cm girth Extra Heavy Standard	1 No
PCC EXH	Pyrus calleryana Chanticleer	N	P	Type of Pear	14-16cm girth Extra Heavy Standard	3 No
SaB EXH	Sorbus aria	N	P	Whitebeam	14-16cm girth Extra Heavy Standard	1 No
Sauc EXH	Sorbus aucuparia	N	P	Rosham	14-16cm girth Extra Heavy Standard	3 No
TcR EXH	Tilia cordata Rancho	N	P	Small leaved lime	14-16cm girth Extra Heavy Standard	2 No
TOTAL						33 No
NATIVE BLOCKS 1-4				NATIVE 1-4		525 m2
Plant at 1.00m cts or 1.20m cts						
Ac	Acer campestre	N	P	Field maple	60-90cm 1+1	250 No
Cm	Crataegus monogyna	N	P	Hawthorn	60-90cm 1+1	225 No
Ca	Corylus avellana	N	P	Hazel	60-90cm 1+1	175 No
Cs	Cornus sanguinea	N	P	Dogwood	60-90cm 1+1	200 No
la	Ilex aquifolium	N	P	Holly	30-45cm 3Lpot	150 No
Lv	Ligustrum vulgare	N	P	Wild Privet	60-90cm 1+1	215 No
Rc	Rosa canina	N	P	Dogr Rose	60-90cm 1+1	10 No
Sn	Sambucus nigra	N	P	Elder	60-90cm 1+1	30 No
Vo	Viburnum opulus	N	P	Guelder Rose	60-90cm 1+1	140 No
TOTAL						2201 No
HEDGEROWS 1						
DOUBLE ROW as indicated						
VEP	Viburnum tinus Eve Price	N	P	Double Row Evergreen Viburnum	Plant at 0.50m cts 40-60cm 3Lpot	25 linn 100 No 100 No
TOTAL						100 No

CA-2025- BKWD-04 Rev A

18 Feb2025

Bird boxes added

Corscadden Associates
77 Fairleigh Road
Cardiff. CF11 9JW
Tel 07966 423074
email ca@corscaddenassociates.com

Project
**PENMAEN ROAD
PONTLLANFRAITH
NP12 2DY**

Drawing Title
**LANDSCAPE PROPOSALS
TREE, NATIVE & HEDGE**

Scale Date
1:500 at A2 30 January 2025

Drawing No
173 CA-2025- BKWD-04 Rev A

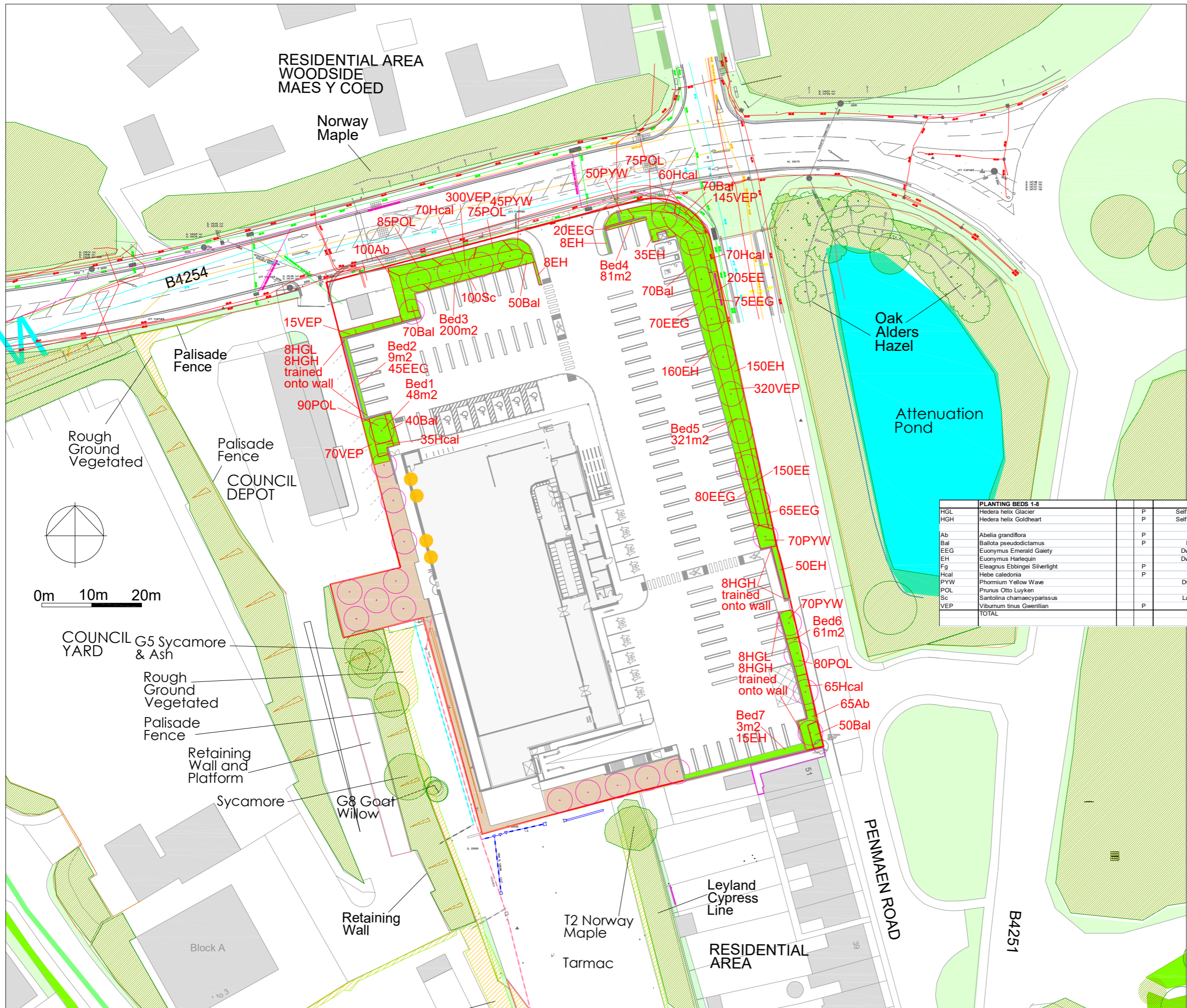

Legend

- Existing Trees and Vegetation
- Grass Areas
- Bank/Contours
- Fence
- Application Boundary
- Proposed Tree Planting
- Proposed Hedge
- Proposed Planting Beds
- Proposed Native blocks
- Sparrow Terrace

In accordance with Ecologist's recommendations

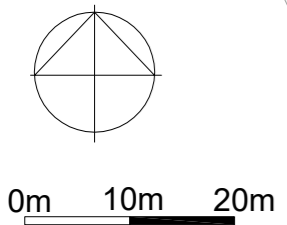

PLANTING BEDS 1-8					
HGL	Hedera helix Glacier	P	Self Clinging Climber	60-90cm 2lpot	16 No
HGH	Hedera helix Goldheart	P	Self Clinging Climber	60-90cm 2lpot	24 No
Ab	Abelia grandiflora	P	Abelia	40-60cm 3lpot	100 No
Bal	Ballota pseudodictamnus	P	False Dittany	20-30cm 2lpot	350 No
EEG	Euonymus Emerald Gaiety	P	Dwarf Euonymus	20-30cm 2lpot	355 No
EH	Euonymus Harlequin	P	Dwarf Euonymus	20-30cm 2lpot	426 No
Fg	Eleagnus Ebberlei Silverlight	P	Eleagnus	40-60cm 3lpot	355 No
Hcal	Hebe caledonia	P	Hebe	20-30cm 2lpot	300 No
PYW	Phormium Yellow Wave	P	Dwarf Phormium	45-60cm 3lpot	235 No
POL	Prunus Otto Luyken	P	Dwarf Laurel	45-60cm 2lpot	405 No
Sc	Santolina chamaecyparissus	P	Lavender Cotton	30-45cm 3lpot	100 No
VEP	Viburnum tinus Gwerillian	P	Viburnum	45-60cm 3lpot	850 No
TOTAL					3516 No

CA-2025- BKWD-05 Rev A
 18 Feb2025
 Bird boxes added

Corscadden Associates
 77 Fairleigh Road
 Cardiff, CF11 9JW
 Tel 07966 423074
 email ca@corscaddenassociates.com

Project
PENMAEN ROAD
PONTLLANFRAITH
NP12 2DY

Drawing Title
LANDSCAPE PROPOSALS
PLANTING BEDS

Scale
 1:500 at A2

Date
 30 January 2025

Drawing No
173 CA-2025- BKWD-05 Rev A

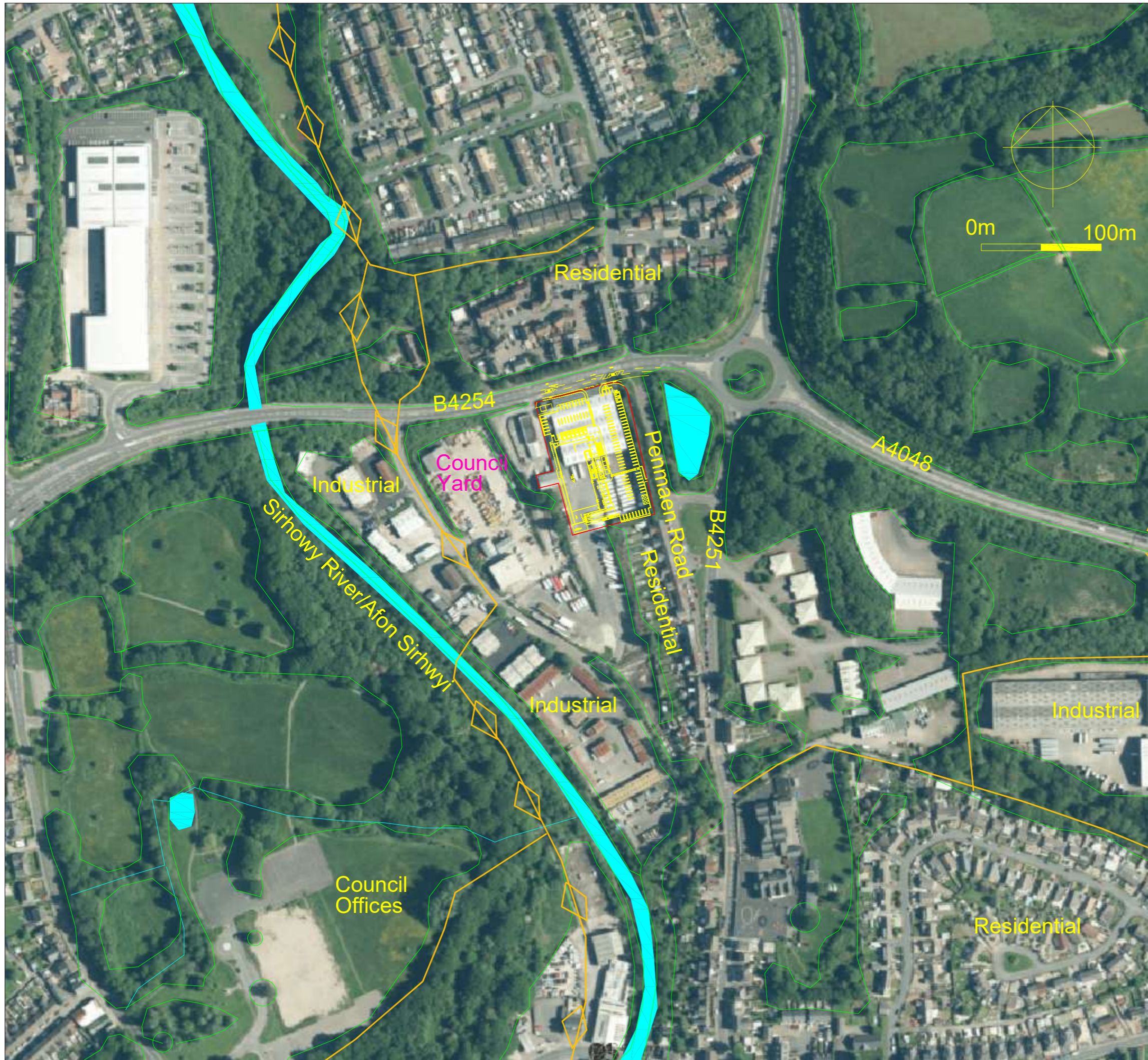

- Green Infrastructure Corridors- trees, hedgerows, grasslands, woods
- Blue Infrastructure Corridors- river ponds & streams
- ▭ Site
- Public Right of Way (PROW)
- Sirhowy Valley Walk

No National Cycle Route near the Site.

The Site lies on the valley floor of the River Sirhowy where there are a number of linear features the A4808, A467 and B4251 and River Sirhowy, which have linear bands of vegetation along them forming ecological corridors except the B4251 which has fragmented planting along its length.

The Site is located in an industrial area between B4251 and the Sirhowy River and below the vegetated B4254. A linear residential area abuts the south end of the Site along Penmaen Road.

The residential is separated from the industrial area by Leyland Cypress conifer lines.

The Site has planting is a combination of trees, native blocks, hedgerow and planting beds on all boundaries to form an ecological band around the Site. It forms ecological links to the B4254, Penmaen Road and B4251 and therefore indirectly to the river to the east and south east and further indirect connections to open space to north west and south east.

Corscadden Associates
 77 Fairleigh Road
 Cardiff. CF11 9JW
 Tel 07966 423074
 email ca@corscaddenassociates.com

Project
**PENMAEN ROAD
 PONTLLANFRAITH
 NP12 2DY**
 Drawing Title
GREEN INFRASTRUCTURE

Scale 1:500 at A2 Date 30 January 2025

Drawing No 173 CA-2025- BKWD-07

KEY	SPECIES	Native	Pollinator	NAME	SIZE	QTY
	All trees to be rootballed for autumn planting/winter planting only All Tree pits 1500 x 1500mm square as indicated					
AcE EXH	Acer campestre Elsrijk	N	P	Field Maple	14-16cm girth Extra Heavy Standard	3 No
ApEQ EXH	Acer platanoides Emerald Queen		P	Norwya Maple	14-16cm girth Extra Heavy Standard	5 No
Ag EXH	Alnus glutinosa	N		Alder	14-16cm girth Extra Heavy Standard	2 No
Bpub EXH	Betula pubescens	N		Downy Birch	14-16cm girth Extra Heavy Standard	3 No
Bp EXH	Betula pendula	N		Silver Birch	14-16cm girth Extra Heavy Standard	1 No
CbL EXH	Carpinus betulus Lucas	N	P	Hornbeam	14-16cm girth Extra Heavy Standard	9 No
Ms EXH	Malus sylvestris	N	P	Crab Apple	14-16cm girth Extra Heavy Standard	1 No
PCC EXH	Pyrus calleryana Chanticleer		P	Type of Pear	14-16cm girth Extra Heavy Standard	3 No
SaB EXH	Sorbus aria	N	P	Whitebeam	14-16cm girth Extra Heavy Standard	1 No
Sauc EXH	Sorbus aucuparia	N	P	Rowan	14-16cm girth Extra Heavy Standard	3 No
TcR EXH	Tilia cordata Rancho	N	P	Small leaved lime	14-16cm girth Extra Heavy Standard	2 No
	TOTAL					33 No
	NATIVE BLOCKS 1-4					525 m2
	NATIVE 1-4 Plant at 1.00m cts or 1.20m cts					
Ac	Acer campestre	N	P	Field maple	60-90cm 1+1	250 No
Cm	Crataegus monogyna	N	P	Hawthorn	60-90cm 1+1	225 No
Ca	Corylus avellana	N	P	Hazel	60-90cm 1+1	175 No
Cs	Cornus sanguinea	N	P	Dogwood	60-90cm 1+1	200 No
la	Ilex aquifolium	N	P	Holly	30-45cm 3Lpot	150 No
Lv	Ligustrum vulgare	N	P	Wild Privet	60-90cm 1+1	215 No
Rc	Rosa canina	N	P	Dogr Rose	60-90cm 1+1	10 No
Sn	Sambucus nigra	N	P	Elder	60-90cm 1+1	30 No
Vo	Viburnum opulus	N	P	Guelder Rose	60-90cm 1+1	140 No
Asp	Aspenium scolopendrium	N		Harts Tongue Fern	2Lpot	20 No
Pset	Polystichum setiferum	N		Evergeen Firm	2Lpot	20 No
HH	Hedera helix Hibernica	N	P	Ivy	60-90cm 2Lpot	766 No
	TOTAL					2201 No
	HEDGEROWS 1					
	DOUBLE ROW as indicated					
VEP	Viburnum tinus Eve Price		P	Double Row Evergreen Viburnum	Plant at 0.50m cts 40-60cm 3LPot	25 linn 100 No
	TOTAL					100 No
	PLANTING BEDS 1-8					723 m2
HGL	Hedera helix Glacier		P	Self Clinging Climber	60-90cm 2Lpot	16 No
HGH	Hedera helix Goldheart		P	Self Clinging Climber	60-90cm 2Lpot	24 No
Ab	Abelia grandiflora		P	Abelia	40-60cm 3Lpot	100 No
Bal	Ballota pseudodictamus		P	False Dittany	20-30cm 2Lpot	350 No
EEG	Euonymus Emerald Gaiety			Dwarf Euonymus	20-30cm 2Lpot	355 No
EH	Euonymus Harlequin			Dwarf Euonymus	20-30cm 2Lpot	426 No
Fg	Eleagnus Ebbingei Silverlight		P	Eleagnus	40-60cm 3Lpot	355 No
Hcal	Hebe caledonia		P	Hebe	20-30cm 2Lpot	300 No
PYW	Phormium Yellow Wave			Dwarf Phormium	45-60cm 3Lpot	235 No
POL	Prunus Otto Luyken			Dwarf Laurel	45-60cm 2Lpot	405 No
Sc	Santolina chamaecyparissus			Lavender Cotton	30-45cm 3Lpot	100 No
VEP	Viburnum tinus Gwenllian		P	Viburnum	45-60cm 3Lpot	850 No
	TOTAL					3516 No