

**LIDL : PONTYMISTER
RISCA
NP11 6EE**

GREEN INFRASTRUCTURE STATEMENT



13 November 2024
25 January 2025

Corscadden Associates
77 Fairleigh Road
Cardiff
CF11 9JW
07966 423074

ca@corscaddenassociates.com

GREEN INFRASTRUCTURE STATEMENT

LIDL STORE : PONTYMISTER : RISCA. NP11 6EE

1.0 INTRODUCTION

This is the Green Infrastructure Statement for the proposed Lidl store and associated carpark. The River Ebbw and a footbridge is south of the Site. The B4591 is east of the Site. To the north a treed open space, garage and commercial properties on Commercial Street. Site access is from Commercial Street with a public right of way and a disused area which forms the west boundary. It has a postal code NP11 6EE and grid reference ST 244898 and is referred to as the 'Site' in this document.

2.0 TERMS

The definition of Green Infrastructure in Chapter 6 of Planning Policy Wales 12 February 2024 is

'Green infrastructure is the network of natural and semi-natural features, green spaces, rivers and lakes that intersperse and connect places. Component elements of green infrastructure can function at different scales and some components, such as trees and woodland, are often universally present and function at all levels. At the landscape scale green infrastructure can comprise entire ecosystems such as wetlands, waterways peatlands and mountain ranges or be connected networks of mosaic habitats, including grasslands. At a local scale, it might comprise parks, fields, public rights of way, allotments, cemeteries and gardens or may be designed or managed features such as sustainable drainage systems.. At smaller scales, individual urban interventions such as street trees, hedgerows, roadside verges, and green roofs/walls can all contribute to green infrastructure networks.'

The Environment (Wales) Act 2016 provides a context for the delivery of multi-functional green infrastructure. Its provision can make a significant contribution to the sustainable management of natural resources. Green infrastructure is capable of providing several functions at the same time and as a result offers multiple benefits, for social, economic and cultural as well as environmental resilience and respond to challenges presented by the climate emergency.

A Step Wise Approach is required to be demonstrated in the Green Infrastructure Statement.

To assess impacts on habitats and species

Step 1 Avoid

Step 2 Minimise

Step 3 Mitigate/Restore

Step 4 Compensate on Site

Step 4 Compensate Off-Site

Steps 1-4 Using the DECCA Framework for all relevant steps that require enhancement

Step 5 Long Term Management Plan

These steps will indicate how Net-Benefit-for-Biodiversity is achieved.

Without an achievement Step 6 would result in a refusal for a development.

Mitigation' to mean 'measures taken to avoid or reduce negative impacts', as separate from 'compensation' meaning 'measures taken to make up for the loss of, or permanent damage to, biological resources through the provision of replacement areas'

3.0 DOCUMENTS

Refer to the following documents as reference for the statement

- CA 2024-RISCA-01 Rev B Existing Features
- CA 2024-RISCA-02 Rev B Landscape Existing Features and Overlay
- CA 2024-RISCA-03 Rev C Landscape Proposals Overall
- CA 2024-RISCA-04 Rev B Landscape Proposals Trees-Hedges-Native

- CA 2024-RISCA-05 Rev B Landscape Proposals Planting Beds-Grass
- CA 2024-RISCA-06 Landscape Sections
- CA 2024-RISCA-07 Rev A Lidl Risca Green Infrastructure
- CA 2024-RISCA-LIDL Pontymister Planting Schedule 13November2024
- CA Pontymister Risca Planting Methodology and 5 Year Aftercare 25January2025.
- Arboricultural Report Land at Pontymister (ArbTS 11 Oct 2024)
- Preliminary Ecological Appraisal BIO23-122/V1 (Biodiverse Consulting, 2024)
- Ecological Management Plan (Biodiverse Consulting.)
- 3067 P407 I GA Proposed Site Plan
-

4.0 EXISTING SITE DETAIL

The existing Site area is 12860m² (1.05Hectares) and 2.59Acres.It is roughly rectangular and is currently a storage facility with a gated access off Commercial Street.

The existing Site access from Commercial Street is a wide bellmouth of mixed hardstanding in variable condition with a verge and parking area and undeveloped site to the west of the Site boundary. The west side of the Site is an area fenced off with a group of Silver Birch and mixed scrub and hardstanding with no management. The public footpath is fenced on both sides with a 2.40m mesh fence up to the footbridge. There is gate into the Site further into the bellmouth.

The southern Site boundary is the northern sloping bank of the River Ebbw. This reprofiled river bank with sloping masonry is rough grass with some sections of scrub. There is a retaining wall at the top of the bank by steps down to the river. The whole of the top of the bank is fenced with Heras fencing.

The east boundary abuts the B4591 and the first section is a fence and internally and on the boundary are three Sycamore and mixed scrub. The second section is Leyland Cypress mature hedge which angles northwards and continues along the north boundary and the canopy extends into the Site.

The northern boundary first section is the Leyland Cypress hedge which is at the back of a grassed open space with mature Horsechestnut, Norway Maple and Fruit Tree just behind the hedge. The grassed space is at the junction of B4591 and Commercial Street. A block of scrub is inside the Site in front of the Leyland hedge. The remainder is a palisade fence to the rear of the garage and commercial premises with two small stands of Japanese Knotweed by the boundary fence. There is a small section of retaining wall by this fence by the commercial properties.

Internally the Site has a variety of hard surfacing sealed and unsealed and covered with stored materials and no scrub or trees.

4.1 EXISTING SITE SUMMARY

The existing site is in two different parts

- Northern river bank of River Ebbw.
- The platform area of the Site.

The existing vegetation is

- 3 Sycamore, 2 Silver Birch and the Leyland Cypress Hedge.
- Rough grass and scrub on the river bank slopes.
- Scrub along sections of the west and east boundary

Constraints to landscaping are the rough grass and scrub areas on the masonry sloped river bank.

5.0 TREES

(The BS5837 tree quality category (A - High, B - Moderate, C - Low and U- Unsuitable for retention)

The Tree Report has surveyed G1 Group of Silver Birch, H1 Leyland Cypress Hedge and T1 – T10 individual trees.

G1 and T1 are both Silver Birches which are near the western boundary G1 are category C trees T1 is a category B tree and both will be retained.

H1 is a mature Leyland Cypress hedge which is on the part of the east and north boundaries and the canopy overhangs the Site and is also a category C. The hedge is to be retained with the loss of a short length to give better visibility of the proposed Site entrance on B4591. Minor trimming of the hedge width may be required on the carpark side of the hedge.

T2 –T7 are mature trees off-site with roots extending together with the conifer hedge roots into the Site on the north east boundary area. They are Horsechestnut, Norway Maple and a Fruit Tree and vary from category C, B and A and are important trees in an open space area at the Junction with B4951 and Commercial Street. The roots of these trees are to be protected. Treeworks are suggested for T5 Fruit tree to reduce the north crown by 3metres to form a more compact crown and as this tree is off-site these works would be by others.

Trees T8, T9 and T10 are Sycamore trees are on the eastern boundary by the fence and are to be removed all are category C trees.

5.1 TREE SUMMARY

In summary there are 1No Tree group , 1No Conifer Hedge and 10No trees surveyed.

- T7-T10 Sycamore removed due the proposed Site entrance and visibility at the entrance
- G1 and T1 Silver Birch are being retained.
- 1 small section of H1 Leyland Cypress to be removed for increased visibility at proposed Site Entrance.
- Tree protection and cell web use as necessary for roots of T2-T7 and H1 Leyland Cypress.

AVOIDANCE MEASURES

- Implementation of fencing for tree protection prior to any demolition or clearance works is to avoid damage to the retained trees.
- Implementation of protection of roots from T2-T7 and H1 Leyland Cypress as construction proceeds in carpark using cell web as recommended by arboriculturalist.
- Tree felling to be undertaken outside the bird nesting season unless checked by a suitably qualified Ecologist and approval given to proceed.

Adhering to the tree protection details in the Arboricultural Report and the compensation for tree and hedgerow loss the proposed development can be constructed without any significant long-term adverse impact on the retained trees and hedge or the area's amenity.

COMPENSATION/ENHANCEMENT

Compensation is proposed to address the impacts on habitats which cannot be avoided or mitigated:

- Tree and hedgerow losses to facilitate the development are to be compensated by new plantings with 25No trees mainly native , native hedges 110 linear metres and native blocks 918 square metres.

6.0 ECOLOGY

6.1 HABITATS

The Preliminary Ecological Assessment (PEA) notes there are no priority habitats on Site and the following habitats on Site are :-

- Grassland 1
- Mixed Scrub – Salix dominant of low value and moderate diversity.
- Mixed Scrub –Buddleia and bramble dominant of low value and moderate diversity.
- Developed Land Sealed Surfaces –area of negligible value.
- Sparsely Vegetated Urban Land – area of low value and low diversity.
- Artificial Unsealed Surfaces - of negligible value.

The current Site boundary excludes the River Ebbw and but includes the northern riverbank and the River Ebbw is a SINC and a Priority Habitat.

- Grasslands – unmanaged of riverbank slopes moderate diversity.
- River Ebbw – SINC status and a Priority Habitat

6.2 PROTECTED AND PRIORITY SPECIES

The protected species which may occur on site are`

- Great Crested Newt
 - Due to lack of connectivity to suitable breeding habitats this species is considered to be absent from the Site and is scoped out of further assessment.
- Bats
 - No roosting potential and limited foraging potential
 - Site considered as low value to bats.
- Birds
 - Overall, the Site is considered to be of local value for birds and further surveys are not recommended. A precautionary approach to safeguard birds during construction, together with post development compensation measures, is recommended.
- Badgers
 - Due to lack of connectivity to suitable habitats this species is considered to be absent from the Site.
- Dormouse
 - Due to lack of connectivity to suitable habitats this species is considered to be absent from the Site.
- Otter
 - The terrestrial habitats within the Site offer poor suitability for otter due to the small areas of vegetation and high levels of disturbance. The habitats along the River Ebbw at this section are largely unsuitable for otter.
- Reptiles
 - It is unlikely that an important assemblage of reptiles is present on Site, and they are therefore scoped out of further assessment, however a precautionary approach will be adopted to safeguard this taxa during construction.
- Hedgehog
 - The Site has the potential to support the priority species hedgehog, with habitats providing some limited suitability for foraging and resting. However, no evidence of this species was found at the time of survey.
- Priority Species
 - The site has the potential to support the priority species of hedgehogs.

6.3 INVASIVE NON-NATIVE SPECIES

Invasive non-native species (INNS) Japanese Knotweed was noted on the northern Site boundary and will be treated and monitored for reoccurrence.

6.4 ECOLOGY SUMMARY

AVOIDANCE

The following measures should be incorporated into the design of the development, including the construction phase, to avoid and reduce impacts on wildlife:

- Retained trees and retained Leyland Cypress hedge section and root spreads of off-site trees extending into the Site to be protected.
- Avoid site clearance works during the nesting bird season (March to August inclusive) unless the site is checked by a Suitably Qualified Ecologist (SQE) and active nests are confirmed to be absent no later than 48 hours before works commence.
- External lighting will be designed in line with BCT Guidance 8 to reduce the impacts on bats and range of other wildlife associated with retained and off-site habitats.
- Schedule 9 invasive species will be removed by a licensed specialist contractor.
- All construction activities will be programmed to daytime hours to reduce disturbance to

sensitive nocturnal species, such as bats and roosting bird species.

MITIGATION

Mitigation is proposed to reduce the impacts on wildlife that cannot be avoided through design:

- All works will be undertaken in accordance with a CEMP (Construction Ecological Management Plan). Ecological receptors likely to be covered in this plan will include, but not be limited to hedgehog, birds and reptiles.
- Excavations should be securely covered or fenced overnight, or otherwise provide a means of escape for animals that may become trapped in the form of a ramp at least 300mm wide and angled no greater than 45°. Excavations should be inspected for the presence of animals before work recommences and, in the event of trapped animals being trapped, an ecologist contacted for advice.
- Gaps of at least 13cm x 13cm will be created within boundaries to facilitate movement of hedgehogs and other small animals through the Site.

COMPENSATION/ENHANCEMENT

Compensation is proposed to address the impacts on habitats which cannot be avoided or mitigated:

- A buffer zone is created between the River Ebbw SINC and the development by retaining the existing grass and scrub blocks on the River bank slopes intact and planting native hedgerows combined with tree planting, native blocks and planting beds for 2/3rds along the top of the bank line. The remaining 1/3rd is a native block planting slit planted into the existing slope where planting space is limited. This enhances the habitat and increases connectivity within the riparian zone.
- The incorporation of roosting bat and nesting bird boxes attached to the store building.
- The Site has existing retained trees and Leyland Cypress hedge and new tree planting of 25 trees with the majority as native species which enhance tree cover.
- Proposed native hedgerows and native blocks and strips occur on all boundaries and combined give connectivity around the Site boundaries and to off-site vegetation including treelines along the river edge near the Site.
- The linear soft landscaping area at the rear of the commercial store is not a public area and will be used for nature conservation with native block planting.
- Trees combined with native shrubs, hedges and pollinator ornamentals are the main biodiversity type for the site. Berrying and fruit-bearing species alongside pollinator species, to provide increased foraging opportunities in the local area.
- An area of wildflower grass around the diverted Public Right of Way to give sense of open space and security for path users before the narrow fenced footbridge. It also introduces a new habitat and increases biodiversity.

6.5 DECCA FRAMEWORK

DIVERSITY

- Genetic and species diversity increased through habitat creation, enhancement and management to promote a greater diversity and number of fauna and flora species using the Site.
- The existing Site had low diversity (apart from the river Ebbw) and the proposed trees, hedgerows, native blocks will increase structural diversity of habitats which will be maintained through habitat enhancement and management.

EXTENT

- The extent of tree, native block, hedgerow and wildflower grassland habitats within the Site is increased by the proposed planting and their management.

CONDITION

- Habitat condition will be improved through habitat creation and enhancement and management which will include invasive species management.

CONNECTIVITY

- Connectivity within the Site will be increased through creation and enhancement of linear boundary habitats.
- Connectivity in the wider landscape will be improved through structural planting on the southern boundary that will provide a buffer and increase in extent of habitats to existing site habitat the River Ebbw.

ASPECTS OF ECOSYSTEM RESILIENCE

- Recovery of ecosystems will be improved through an increase in the diversity of habitats and increased connectivity and management.

7.0 DRAINAGE AND BUILDING

- The proposed Site will have hard surfaces with gullies and drains the proposed scheme will ensure water pollution into the adjacent River Ebbw will be avoided. This is of great importance due to the status of the River Ebbw as an SINC.
- The Building is designed to have photovoltaics on the roof to reduce the required power input from the grid for the operation of the store.

AVOIDANCE

- Ensure drainage system avoids pollution into adjacent River Ebbw.

8.0 SITE SETTING

The Site and designated areas or within the Site or 2 Kilometres are as follows:

DESIGNATIONS

- National Landscape Character Area NLCA35 Cardiff and Newport and NCLA37 South Wales Valleys.

The Site is located on boundary of two National Character Areas. Within the Cardiff and Newport Character is in the lowland river corridor of the River Ebbw of one of the most urbanised busy areas in Wales. The River Ebbw forms a wooded river corridor through a urbanised valley floor with wooded agricultural fields up the valley sides.

Within the South Wales Valley Character is extensive ribbon developments filling many valley bottoms and lower slopes. Their urban and industrial character is juxtaposed with dramatic upland settings with steep hillsides, open moors or forests. Networks of railways and roads connect valley settlements. Topography constrains passage between valleys, and there are only a limited number of high passes between valleys. The noise and business of many valleys contrast with the relatively remote and wild qualities of adjacent hill plateaux.

Yet today a new image is gradually but fundamentally changing the old one. Modern road improvements and bypasses bristle with street lighting, spreading the urban influence beyond the old settlement envelopes and altering the character experienced when travelling.

IMPACT LOW

- SSSI Dan y Graig Quarry: 1300m from Site, designated for its geological and geomorphological value. NO IMPACT
- SINC River Ebbw– within the Site boundary, designated for anadromous fish species and otter. VULNERABLE : AVOIDANCE MEASURES needed to avoid pollution.
- SINC Ochwrth Grassland : 590m from Site, designated species rich neutral grassland with waxcap. NO IMPACT
- SINC Monmouth to Brecon Canal 600m from Site. designated for wetland and woodland habitat. NO IMPACT
- SINC Coed Mawr West 600m from Site, designated for ancient woodland. NO IMPACT
- SINC Coed y Mochyn 840m from Site, designated for woodland and calcareous grasslands. NO IMPACT
- SINC Mynydd machen 950m from Site, designated for acid and calcareous grasslands. NO IMPACT
- SINC Ty-Sign Meadows 980m from Site, designated for species rich grasslands. NO IMPACT

URBAN SETTING

The Site is either within or connected or outside and not connected to any of the following:

- It is within a retail area north of River Ebbw and is one of the opportunity areas for Risca and Pontymister Town Centre
- No connections to the National Cycle Route No47

- The open spaces close to the Site are:
 - Junction grass area north of the Site mirrored by similar space on the other side of B4591
 - Recreation and Cricket ground to the east with footpath and road access and footbridge crossing River Ebbw to a riverside walk. It links to a footbridge over the A467 giving access to a range of footpaths including the Sirhowy Valley Walk.
 - Road with footpaths linking to football ground and associated pitches to the north of the Site near railway line.
- Public Rights of Way
 - There is a public right of way through the Site on the western side and across a footbridge into the edge of an industrial area and gives access to the Tesco Extra and its landscaping and a landscaped path by the river. Going through roads and footpaths of the industrial area leads to a footpath over the A467. This similarly to the other road footbridge gives access to a range of footpaths including Sirhowy Valley Walk.

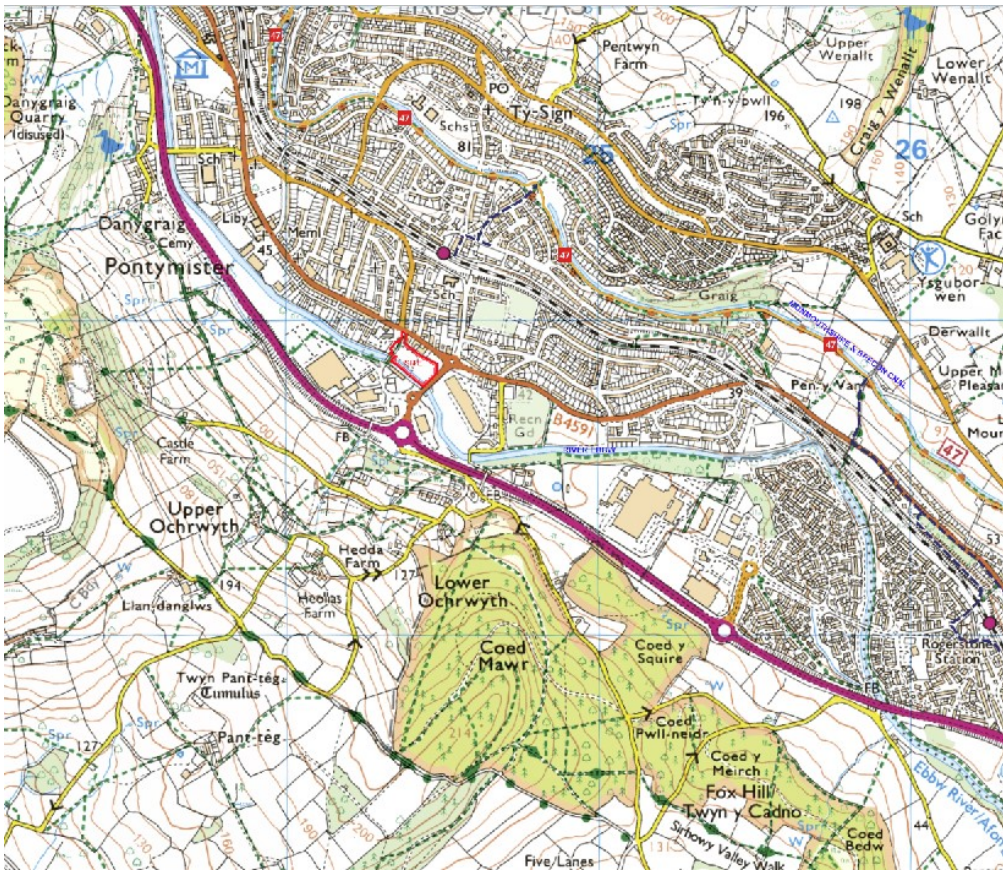

GREEN AND BLUE INFRASTRUCTURE

The Site is part of a Green Blue Infrastructure in an urban area.

The Blue Infrastructure is the River Ebbw and the number of streams flowing into the river from the south west valley sides. The River Sirhowy merges with the River Ebbw west of the Site. The Monmouthshire and Brecon Canal lies north and collects water from streams on the north east valley sides and is unconnected to the River Ebbw due to separation by the railway line and major roads in the valley floor.

The Green Infrastructure of the Site is connected to the green network in adjacent areas.

The Site lies on the valley floor of the River Ebbw where there are a number of linear features the A467, River Ebbw, Railway line and Brecon & Monmouthshire Canal and National Cycle Route 47 all of which have linear bands of vegetation along them forming ecological corridors. The A467 and River Ebbw have combined vegetation lines in places. Commercial Street another linear feature to the north of the Site has limited vegetation and does not form a linear corridor except at the junction with

the B4591 where the conifer hedge and mature tree group link to lines of vegetation on the other side of the B4591 and the route of the B4591 eastwards which links back to the river.

The woodlands, trees, hedgerows and fields on the south west valley sides form links to the river and A 467. The Site has planting is a combination of trees, native blocks, native hedgerows and planting beds on all boundaries to form an ecological band around the Site. It forms ecological links to the river on the south west and east boundaries. To the north there are only fragmented groups of vegetation which form weak links to the railway vegetation lines.

The proposed development also creates new and enhanced local habitats with the increase species diversity.

9.0 LONG TERM MANAGEMENT

The site will have a Planting Methodology 5 Year Landscape Management Plan which will include landscape annual inspections and reports to assess the establishment of the landscape and undertake defects replacements in this period and will be copied to the ecologist. The ecologist will undertake monitoring inspections in years 1 and 5 additional visits if annual reports raise issues. Revisions to the management plan will be made as necessary to assist successful establishment.

10.0 SUMMARY OF SITE AND NET BIODIVERSITY GAIN.

The northern sloped river bank are to be retained intact with only minimal actions occurring at the top edge and slit planting at parts of the top edge. The existing development platform has overall limited boundary vegetation with just a storage area with no significant ground cover vegetation in the internal area. Birch trees and the majority of the Leyland Cypress are retained and 3 No Sycamore trees and scrub are removed. The general development platform has low ecological value and limited biodiversity.

Tree and hedgerow losses to facilitate the development are to be compensated by new plantings with 25 No trees mainly native, native hedges 110 linear metres, native blocks 918 square metres, planting beds 379 square metres and wildflower grass areas 585 square metres. The proposed site will provide an improvement in connectivity by planting on all boundaries. which link to off-site vegetation on the west boundary, north east boundary and along the River Ebbw vegetated river

The Statement undertakes the Step system showing the Avoidance and Mitigation measures undertaken, Compensation made on Site. Long term management for the successful landscape establishment will ensure biodiversity objectives are met.

Overall the proposals, considering the location of the Site in this retail area of Pontymister and the Site's current low ecological value with limited diversity, will provide a biodiversity net gain.

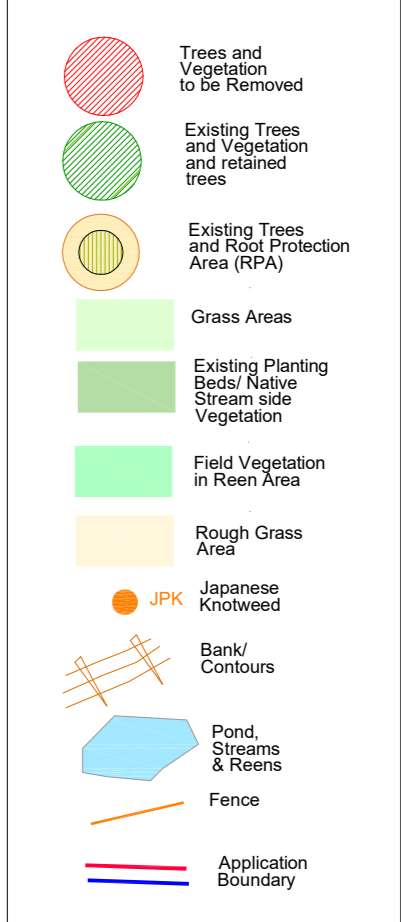
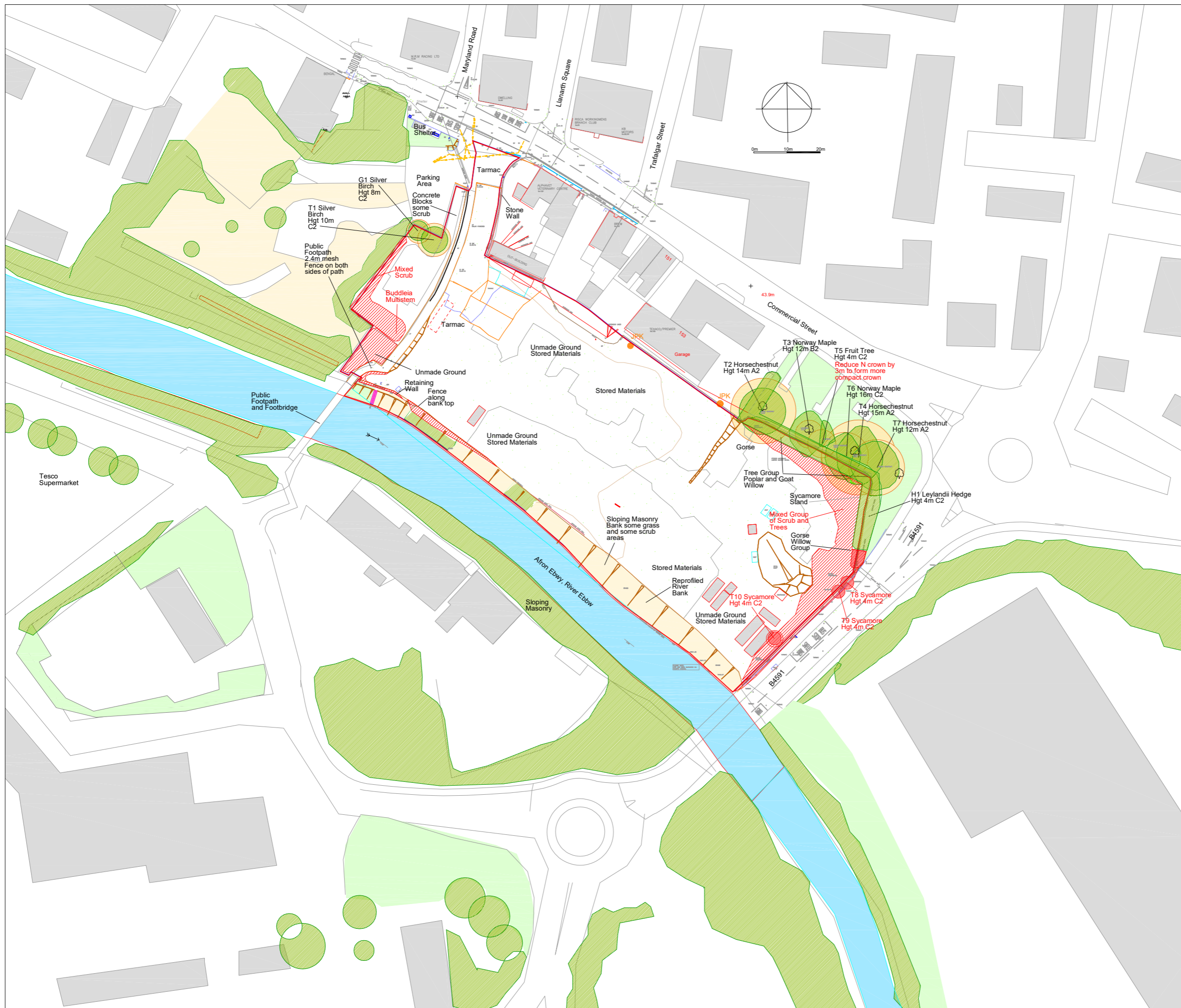

CA-2024- RISCA-01revA
 25 Oct 2024
 Tree Survey detail added.

CA-2024- RISCA-01revB
 25 Jan 2025
 Boundary line revised.

Corscadden Associates
 77 Fairleigh Road
 Cardiff. CF11 9JW
 Tel 07966 423074
 email ca@corscaddenassociates.com

Project
PONTYMISTER
RISCA
NP11 6EE
 Drawing Title
EXISTING FEATURES

Scale Date
 1:750 at A2 9 July 2024

Drawing No
173 CA-2024- RISCA-01revB

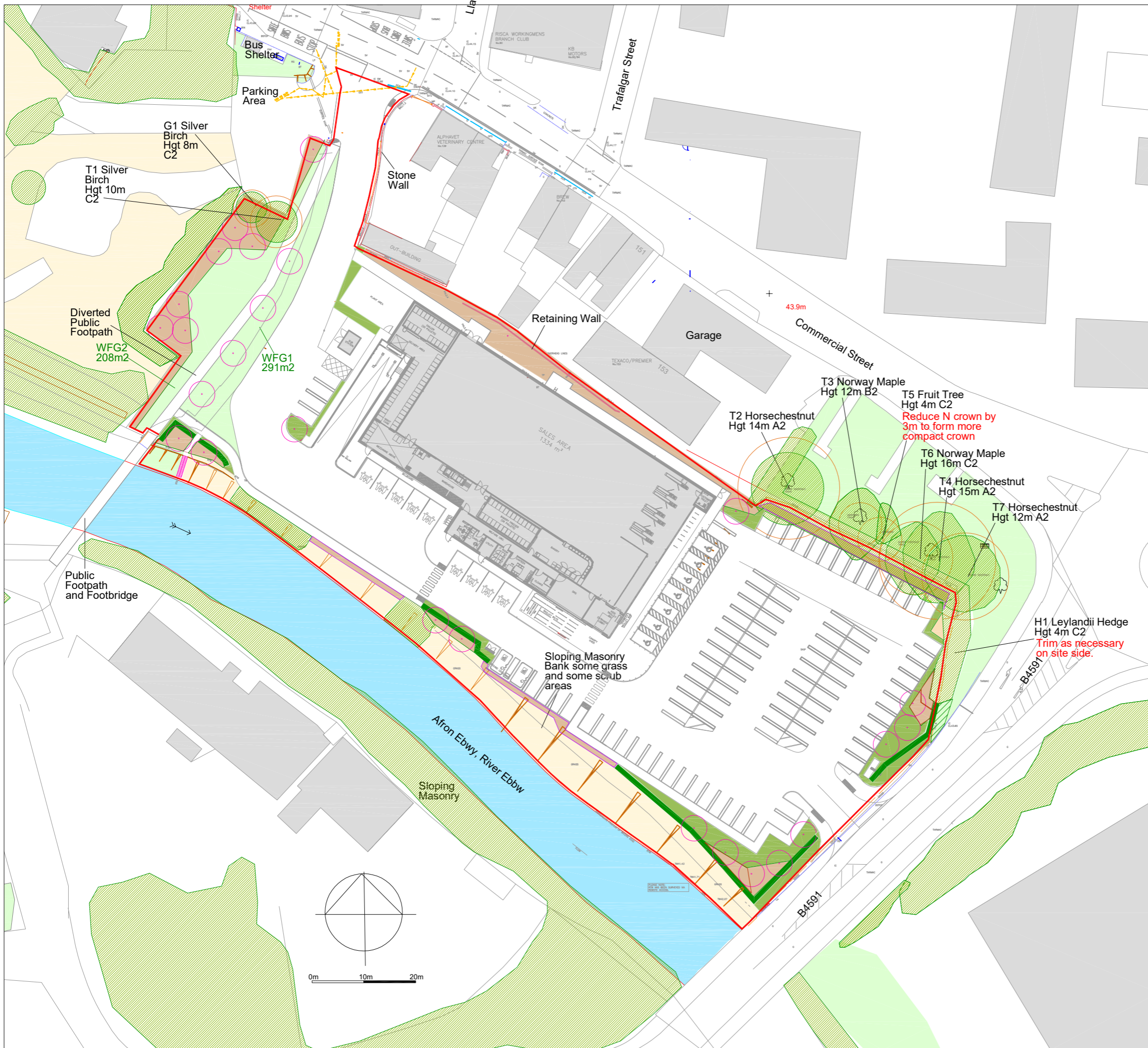

	Proposed Tree Planting		Existing Trees and Vegetation and retained trees
	Proposed Hedge		Grass Areas
	Proposed Planting Beds		Rough Grass Area
	Proposed Native blocks		Bank/Contours
	Proposed Slit/Pit Planted Native blocks		River
	Bat Box x2		Fence
	Bird Box x2		Application Boundary
Locate in accordance with Ecologist's recommendations			

CA-2024- RISCA-03 RevA
 9 November 2024
 Revised Landscape

CA-2024- RISCA-03 RevB
 13 November 2024
 Retaining wall added

CA-2024- RISCA-03 revC
 25 Jan 2025
 Boundary line revised.

Corscadden Associates
 77 Fairleigh Road
 Cardiff, CF11 9JW
 Tel 07966 423074
 email ca@corscaddenassociates.com

Project
PONTYMISTER
RISCA
NP11 6EE

Drawing Title
LANDSCAPE
PROPOSALS OVERALL

Scale
 1:500 at A2

Date
 3 November 2024

Drawing No
173 CA-2024- RISCA-03 RevC

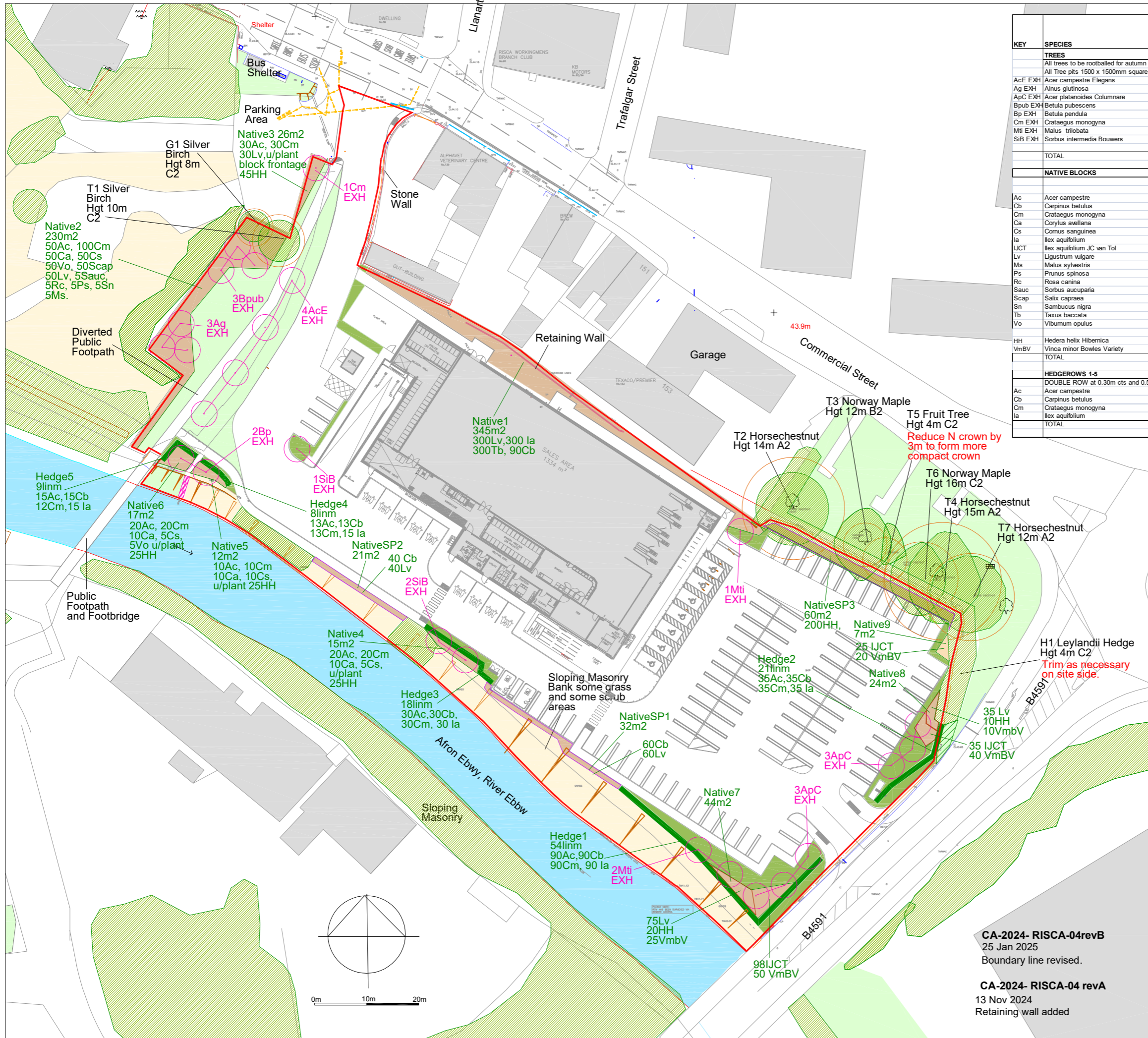

KEY	SPECIES	Native	Pollinator	NAME	SIZE	QTY
TREES						
All trees to be rootballed for autumn planting/winter planting only						
All Tree pits 1500 x 1500mm square as indicated						
AcE EXH	Acer campestre Elegans	N	P	Field Maple	14-16cm girth Extra Heavy Standard	4 No
Ag EXH	Alnus glutinosa	N		Alder	14-16cm girth Extra Heavy Standard	3 No
ApC EXH	Acer platanoides Columnare	N	P	Norway Maple	14-16cm girth Extra Heavy Standard	6 No
Bpub EXH	Betula pubescens	N		Downy Birch	14-16cm girth Extra Heavy Standard	3 No
Bp EXH	Betula pendula	N		Silver Birch	14-16cm girth Extra Heavy Standard	3 No
Cm EXH	Crataegus monogyna	N	P	Hawthorn	14-16cm girth Extra Heavy Standard	1 No
Mti EXH	Malus trilobata	N	P	Crab Apple	14-16cm girth Extra Heavy Standard	3 No
SiB EXH	Sorbus intermedia Bouwers	N	P	Whitebeam	14-16cm girth Extra Heavy Standard	3 No
TOTAL						26 No
NATIVE BLOCKS						
NATIVE 1-9. NativePits1-3						
Plant at 5 per sqm in small blocks						
Pit Planting at 0.30m cts						
Spacing as indicated in Blocks 1&2						
Ac	Acer campestre	N	P	Field Maple	60-90cm 1+1	130 No
Cb	Carpinus betulus	N	P	Hornbeam	60-90cm 1+1	190 No
Cm	Crataegus monogyna	N	P	Hawthorn	60-90cm 1+1	180 No
Ca	Corylus avellana	N	P	Hazel	60-90cm 1+1	80 No
Cs	Cornus sanguinea	N	P	Dogwood	60-90cm 1+1	70 No
la	Ilex aquifolium	N	P	Holly	30-45cm 3Lpot	300 No
IJCT	Ilex aquifolium JC van Tol	N	P	Form of Holly	30-45cm 3Lpot	158 No
Lv	Ligustrum vulgare	N	P	Wild Privet	60-90cm 1+1	590 No
Ms	Malus sylvestris	N	P	Crab Apple	60-90cm 1+1	5 No
Ps	Prunus spinosa	N	P	Blackthorn	60-90cm 1+1	5 No
Rc	Rosa canina	N	P	Dog Rose	60-90cm 1+1	5 No
Sauc	Sorbus aucuparia	N	P	Rowan	60-90cm 1+1	5 No
Scap	Salix caprea	N	P	Goat Willow	60-90cm 0/1	50 No
Sn	Sambucus nigra	N	P	Elder	60-90cm 1+1	5 No
Tb	Taxus baccata	N	P	Yew	30-45cm 3Lpot	300 No
Vo	Viburnum opulus	N	P	Guelder Rose	60-90cm 1+1	55 No
HH	Hedera helix Hibernica	N	P	Ivy	60-90cm 2Lpot	350 No
VmBV	Vinca minor Bowles Variety	N		Periwinkle	2Lpot	135 No
TOTAL						2613 No
HEDGEROWS 1-5						
DOUBLE ROW at 0.30m cts and 0.50m apart						
Ac	Acer campestre	N	P	Field Maple	60-90cm 1+1	183 No
Cb	Carpinus betulus	N		Hornbeam	60-90cm 1+1	183 No
Cm	Crataegus monogyna	N	P	Hawthorn	60-90cm 1+1	183 No
la	Ilex aquifolium	N	P	Holly	40-60cm 3Lpot	183 No
TOTAL						732 No

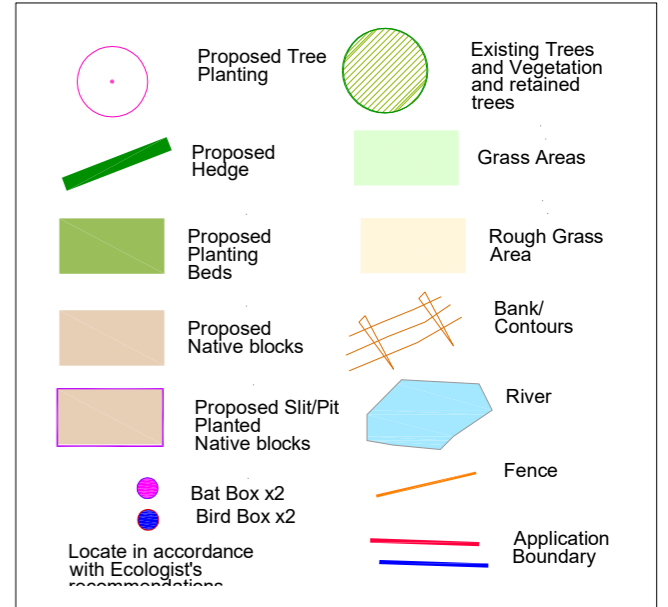

Corscadden Associates
 77 Fairleigh Road
 Cardiff, CF11 9JW
 Tel 07966 423074
 email ca@corscaddenassociates.com

Project
**PONTYMISTER
 RISCA
 NP11 6EE**

Drawing Title
**LANDSCAPE TREES,
 HEDGE & NATIVE BLOCKS**

Scale 1:500 at A2 Date 3 November 2024

Drawing No
173 CA-2024- RISCA-04 revB

CA-2024- RISCA-04revB
 25 Jan 2025
 Boundary line revised.

CA-2024- RISCA-04 revA
 13 Nov 2024
 Retaining wall added

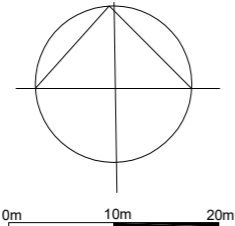



- Green Infrastructure Corridors- trees, hedgerows, grasslands, woods
- Blue Infrastructure Corridors- river ponds & streams
- Site
- Public Right of Way (PROW)
- Sirhowy Valley Walk
- Route with Public Access

The Site lies on the valley floor of the River Ebbw where there are a number of linear features the A467, River Ebbw, Railway line and Brecon & Monmouthshire Canal and National Cycle Route 47 all of which have linear bands of vegetation along them forming ecological corridors. The A467 and River Ebbw have combined vegetation lines in places. Commercial Street another linear feature to the north of the Site has limited vegetation and does not form a linear corridor except at the junction with the B4591 where the conifer hedge and mature tree group link to lines of vegetation on the other side of the B4591 and the route of the B4591 eastwards which links back to the river.

The woodlands, trees, hedgerows and fields on the south west valley sides form links to the river and A 467. The Site has planting is a combination of tress, native blocks, native hedgerows and planting beds on all boundaries to form an ecological band around the Site. It forms ecological links to the river on the south west and east boundaries. To the north there are only fragmented groups of vegetation which form weak links to the railway vegetation lines.

Corscadden Associates
 77 Fairleigh Road
 Cardiff, CF11 9JW
 Tel 07966 423074
 email ca@corscaddenassociates.com

Project
**PONTYMISTER
 RISCA
 NP11 6EE**

Drawing Title
GREEN INFRASTRUCTURE

Scale as given Date 13 November 2024

Drawing No
173 CA-2024- RISCA-07revA

CA-2024- RISCA-07revA
 25 Jan 2025
 Boundary line revised

LIDL STORE : PONTYMISTER : RISCA: NP11 6EE				09-Nov-24 Rev13 Nov2024		
KEY	SPECIES	Native	Pollinator	NAME	SIZE	QTY
TREES						
All trees to be rootballed for autumn planting/winter planting only All Tree pits 1500 x 1500mm square as indicated						
AcE EXH	Acer campestre Elegans	N	P	Field Maple	14-16cm girth Extra Heavy Standard	4 No
Ag EXH	Alnus glutinosa	N		Alder	14-16cm girth Extra Heavy Standard	3 No
ApC EXH	Acer platanoides Columnare		P	Norway Maple	14-16cm girth Extra Heavy Standard	6 No
Bpub EXH	Betula pubescens	N		Downy Birch	14-16cm girth Extra Heavy Standard	3 No
Bp EXH	Betula pendula	N		Silver Birch	14-16cm girth Extra Heavy Standard	3 No
Cm EXH	Crataegus monogyna	N	P	Hawthorn	14-16cm girth Extra Heavy Standard	1 No
Mti EXH	Malus trilobata	N	P	Crab Apple	14-16cm girth Extra Heavy Standard	3 No
SiB EXH	Sorbus intermedia Bouwers	N	P	Whitebeam	14-16cm girth Extra Heavy Standard	3 No
TOTAL						26 No
NATIVE BLOCKS				NATIVE 1-9. NativePits1-3		918 m2
				Plant at 5 per sqm in small blocks Pit Planting at 0.30m cts	Spacing as indicated in Blocks 1&2	
Ac	Acer campestre	N	P	Field Maple	60-90cm 1+1	130 No
Cb	Carpinus betulus	N	P	Hornbeam	60-90cm 1+1	190 No
Cm	Crataegus monogyna	N	P	Hawthorn	60-90cm 1+1	180 No
Ca	Corylus avellana	N	P	Hazel	60-90cm 1+1	80 No
Cs	Cornus sanguinea	N	P	Dogwood	60-90cm 1+1	70 No
la	Ilex aquifolium	N	P	Holly	30-45cm 3Lpot	300 No
IJCT	Ilex aquifolium JC van Tol		P	Form of Holly	30-45cm 3Lpot	158 No
Lv	Ligustrum vulgare	N	P	Wild Privet	60-90cm 1+1	590 No
Ms	Malus sylvestris	N	P	Crab Apple	60-90cm 1+1	5 No
Ps	Prunus spinosa	N	P	Blackthorn	60-90cm 1+1	5 No
Rc	Rosa canina	N	P	Dog Rose	60-90cm 1+1	5 No
Sauc	Sorbus aucuparia	N	P	Rowan	60-90cm 1+1	5 No
Scap	Salix capraea	N	P	Goat Willow	60-90cm 0/1	50 No
Sn	Sambucus nigra	N	P	Elder	60-90cm 1+1	5 No
Tb	Taxus baccata	N	P	Yew	30-45cm 3Lpot	300 No
Vo	Viburnum opulus	N	P	Guelder Rose	60-90cm 1+1	55 No
HH	Hedera helix Hibernica	N	P	Ivy	60-90cm 2Lpot	350 No
VmBV	Vinca minor Bowles Variety			Periwinkle	2Lpot	135 No
TOTAL						2613 No
HEDGEROWS 1-5				HEDGE 1-5		110 linm
				DOUBLE ROW at 0.30m cts and 0.50m apart		
Ac	Acer campestre	N	P	Field Maple	60-90cm 1+1	183 No
Cb	Carpinus betulus	N		Hornbeam	60-90cm 1+1	183 No
Cm	Crataegus monogyna	N	P	Hawthorn	60-90cm 1+1	183 No
la	Ilex aquifolium	N	P	Holly	40-60cm 3Lpot	183 No
TOTAL						732 No
PLANTING BEDS 1-11						379 m2
Ab	Abelia grandiflora		P	Abelia	40-60cm 3Lpot	50 No
Bal	Ballota pseudodictamus		P	False Dittany	20-30cm 2Lpot	275 No
CAZ	Choisya Aztec Pearl			Mexican Orange	45-60cm 3Lpot	160 No
EPB	Euonymus Paloma Blanca			Dwarf Euonymus	20-30cm 2Lpot	235 No
EH	Euonymus Harlequin			Dwarf Euonymus	20-30cm 2Lpot	320 No
Hbux	Hebe buxifolia		P	Hebe	2Lpot	117 No
Hcal	Hebe caledonia		P	Hebe	20-30cm 2Lpot	135 No
POL	Prunus Otto Luyken			Dwarf Laurel	45-60cm 2Lpot	280 No
VEP	Viburnum tinus Gwenllian		P	Viburnum	45-60cm 3Lpot	45 No
VmBV	Vinca minor Bowles Variety			Periwinkle	20-30cm 2Lpot	185 No
TOTAL						1802 No
WILD FLOWER GRASS AREAS				WFG1-2		585 m2
EM1 STANDARD GENERAL PURPOSE MEADOW MIXTURE						
Emorsgate Seeds enquires@emorsgateseeds.com 01553 829028						
	Agrostis capillaris	N		Common Bent	GRASSES 90%	9 %
	Cynosurus cristatus	N		Crested Dogstail		31.5 %
	Festuca rubra	N		Slender Creeping Red Fescue		27 %
	Phleum bertolonii	N		Smaller Cat's Tail		4.5 %
	Poa pratensis	N		Smooth-stalked Meadow Grass		18 %
WILDFLOWERS 10%						
	Centaurea nigra	N	P	Common Knapweed		1.5 %
	Daucus carota	N	P	Wild Carrot		0.6 %
	Galium verum	N	P	Lady's Bedstraw		0.5 %
	Leucanthemum vulgare	N	P	Ox Eye Daisy		1.5 %
	Malva moschata	N	P	Musk Mallow		1.5 %
	Plantago lanceolata	N	P	Ribwort Plantain		1.9 %
	Poterium sanguisorba ssp snaguisorba	N	P	Salad Burnet		1.5 %
	Rhinanthus minor	N	P	Yellow Rattle		0.5 %
	Silene dioica	N	P	Red Campion		0.5 %
TOTAL						100 %
sow at rate of 4gms per sqm						