



**ArbTS - Arboricultural Technician Services Ltd**

(Tree Consultancy Services)

Stephen Lucocq *BSc (Hons), Tech Cert (ArborA), M.Arbor.A*  
*Professional Member of the Arboricultural Association*

Web site: [www.ArbTS.co.uk](http://www.ArbTS.co.uk)

Email: [info@ArbTS.co.uk](mailto:info@ArbTS.co.uk)

Phone: (01639) 849 877

Mobile: 07789 551 591

## Arboricultural Report

Including:

Tree Survey Data

&

Tree Constraints Plan (TCP)

To the British Standard 5837:2012  
*(Trees in relation to design, demolition  
and construction. Recommendations)*

Date – 5<sup>th</sup> February 2025

Site – Risca

Project Reference – ArbTS\_2093.1\_Risca

## Table of Contents

1.0	Introduction	3
2.0	The Tree Survey	3
3.0	The Trees	4
4.0	Tree Constraints Plan Information	4
5.0	Tree Protection Information	5
6.0	Conclusion	5
7.0	Qualifications & Further Information	6
8.0	Bibliography & Web Information	7
9.0	Appendix	
	1A	Tree Survey Data
	1B	Detailed Tree Survey Data Summary
	2	Tree Constraints Plan
	3	Tree Survey Key
	4	An Introduction to Tree Protection
	5	Tree Photographs

### Copyright © 2025

Arboricultural Technician Services Ltd (ArbTS), 5 Weavers Road, Ystradgynlais, Powys, SA9 1PQ. All rights reserved.

No part of this report may be copied or reproduced without prior written permission from ArbTS.

If you have received this report in error, please destroy all copies in your possession or control.

This report has been prepared for the exclusive use of the commissioning party, and unless otherwise agreed in writing by ArbTS, no other party may use, make use of or rely on the contents of this report.

ArbTS accept no liability for any use of this report other than for the purposes for which it was initially prepared and provided.

Opinions and information provided in the report are based on ArbTS using due skill, care and diligence in the preparation of the same and no warranty is provided as to their accuracy.

Surveys are undertaken to ensure that nothing in the final report will be omitted, amended or misrepresented by the client or any other interested party.

This report and its contents remain the property of ArbTS until payment has been made in full.

It should be noted, and it is expressly stated, that no independent verification of any of the documents or information supplied to ArbTS has been made.

## 1.0 Introduction

- 1.1 The purpose of this report is to assess the quality and constraints of the trees at a site in Risca. The findings of this survey will be used to inform future design proposals and to preserve and minimise damage to the important trees on or adjacent to this site.
- 1.2 This report identifies the quality of the trees on or adjacent to this site as categorised by the *British Standard 5837:2012, Trees in relation to design, demolition and construction - Recommendations*. The survey and findings, as reported here, represent an unbiased third-party opinion offering professional advice on the value of the trees on this site. A Tree Constraints Plan (TCP) has been drawn, as found in Appendix 2, to illustrate the constraints identified trees pose to the design of future development.
- 1.3 Arboricultural constraints within the surveyed site relate primarily to the preservation of trees recommended for retention. Identified trees must be protected during the construction phase by employing a combination of protective barriers, ground protection zones and tree-safe construction methods designed by a suitably qualified Arboriculturist.
- 1.4 The trees' root systems and associated soil structure are often overlooked during construction. They can be damaged or altered by compaction, causing major damage to the tree's health. Generally, the tree's entire root system is within the top 600mm of soil, where it can be easily damaged. A calculated ground area around the tree should be protected during the onsite construction phase. In this report, it is referred to as the Root Protection Area (RPA).
- 1.5 No Arboricultural Impact Assessment, Tree Protection Plan or Tree Protection Method Statement are included within this report. No assessment has been made regarding the suitability of the proposed development design within this report.

## 2.0 The Tree Survey

- 2.1 The tree survey was conducted by Stephen Lucocq *BSc (Hons), Tech Cert (ArborA), M.Arbor.A* on 3<sup>rd</sup> February 2025.
- 2.2 Trees over 75mm were tagged where appropriate with numbered metal identification tags at around 2.0 metres above ground level.
- 2.3 All observations were made from the ground with an acoustic-sounding hammer. No invasive decay detective instruments were used.
- 2.4 The survey was carried out per *British Standard 5837:2012, Trees in relation to design, demolition and construction - Recommendations*. This standard gives a systematic, consistent, transparent evaluation method for tree surveying.
- 2.5 The survey was conducted with the aid of a topographical survey.

- 2.6 **Preliminary management recommendations:** The survey has identified preliminary management recommendations for the trees on or adjacent to this site. Details regarding these specified operations are given in this report (See Appendix 1 - Tree Survey Data). Where work priority is stated to be H – High due to safety reasons, these operations should be carried out as soon as possible. Where work priority is said to be M/H – medium/high or higher, these operations should be undertaken before the commencement of any works on site.
- 2.7 **Limitations of the tree survey:** Whilst every effort is made to ensure an accurate assessment of the tree's condition during the survey, no responsibility can be taken for resultant damage or injury that occurred by a failing tree. The survey only gives a snapshot of what is visible and is not obscured on the day of the survey. The survey identifies trees of varying quality and their above-ground/below-ground constraints. This survey does not constitute a full tree condition/tree risk assessment of the site, and this report is only valid for 24 months from the date of the tree survey.

### 3.0 The Trees

- 3.1 The complete tree survey data can be found in Appendix 1A Tree Survey Data.
- 3.2 Tree Survey Summary Table (See Appendix 3 for BS5837 category definitions). (A more detailed Tree Survey Data Summary can be found in Appendix 1B)

BS5837:2012 Quality Category	Total Number of Individual Trees Surveyed	Total Number of Tree Groups Surveyed	Total Number of Tree Areas Surveyed	Total Number of Woodland Areas Surveyed	Total Number of Hedgerows Surveyed	Total
<b>A</b> (High - Most desirable for retention)	0	0	0	0	0	0
<b>B</b> (Moderate - Desirable for retention)	0	0	0	0	0	0
<b>C</b> (Low - Optional for retention)	0	1	0	0	0	1
<b>U</b> (Poor - Unsuitable for retention)	0	0	0	0	0	0
<b>Total A,B,C,U</b>	0	1	0	0	0	1

### 4.0 Tree Constraints Plan (TCP) Information

- 4.1 A Tree Constraints Plan (TCP) can be found in Appendix 2 of this report. An introduction to TCP can also be found in Appendix 2. For further information and details regarding TCP please see the *British Standard 5837:2012, Trees in relation to design, demolition and construction – Recommendations*.

## **5.0 Tree Protection Information**

- 5.1 No Arboricultural Impact Assessment, Tree Protection Plan or Tree Protection Method Statement are included within this report for the proposed development design. An introduction to Tree Protection can be found in Appendix 4.

## **6.0 Conclusion**

- 6.1 This site has no significant trees, which will present a major constraint on its development. Retaining these trees is optional within the proposed development design. However, if these trees are to be removed, suitable mitigative tree planting should be considered.

## 7.0 Further Information & Qualifications

Stephen Lucocq has been involved in Arboriculture within South Wales for over twenty years. He has worked as an Arborist for many of these years and has an excellent working knowledge of the practical side of the profession. He has always taken an active interest in all areas of Arboriculture and kept up to date with current research and developments.

### Qualifications

- First Class BSc (Hons) Degree – Combined Studies - Biology and IT
- Arboricultural Association Technicians Certificate – Level 4 - (Merit)
- PTI - Professional Tree Inspection (Lantra Awards)
- 2D Computer-Aided Design (City and Guilds - Level 3)
- Quantified Tree Risk Assessment (QTRA) – Mike Ellison
- Visual Tree Assessment (VTA) – Mike Ellison
- Arboriculture and Bats (Lantra)
- Industrial Rope Access Trade Association (IRATA)
- Practical Arboriculture Qualifications (NPTC)

### Membership

- Arboricultural Association Professional Member (*M.Arbor.A*)

## 8.0 Web Information & Bibliography

### Web Information

- Arboricultural Association  
<http://www.trees.org.uk/>
- Cellular Confinement System  
**GeoWeb** - [GreenFix](#)  
**CellWeb** - [Geosynthetics](#) [Cellweb](#)
- Underground Utilities Installation  
<http://www.njug.org.uk/>

### Bibliography

- British Standards 3998 (2010) Recommendations for Tree Work UK; British Standards Intuition
- British Standard 5837:2012, Trees in relation to design, demolition and construction - Recommendations UK; British Standards Intuition
- Coombes, A.J (1992) Trees London; Dorling Kindersley
- Lonsdale, D (1999) Principle of Tree Hazard Assessment and Management Edinburgh; Forestry Commission
- Mattheck, C (2007) Field Guide for Visual Tree Assessment Germany; Karlsruhe Research Centre
- Shigo, A.L (1991) Modern Arboriculture USA; Shigo and Trees, Association
- Sterry, P (2007) Collins Complete British Trees London; Collins
- Strouts, R.G (2000) Diagnosis of ill-health in trees Edinburgh; Forestry Commission
- Weber, K & Mattheck, C (2003) Manual of wood decay UK; Arboricultural Association

## **9.0 Appendix 1A -Tree Survey Data**



Tree ID #	Tree Species	Age	Stems	Stem Diam (mm)	Cat	Height + (Lower Branch Height)	Nrth	Est	Sth	Wst	Phys Cond	Struc Cond	Est. Remain Contrib	Comments	Preliminary Management Recommendations	Work Priority	RPR (m)	RPA (m2)
G1	Alnus glutinosa (Common Alder),Sambucus nigra (Elder),Salix caprea (Goat Willow),Betula pendula (Silver Birch),Acer pseudoplatanus (Sycamore),Fraxinus excelsior (Ash)	EM	1	250	C2	13(0)	4	4	4	4	G/F	N/A	20+	Surrounding vegetation prevented close inspection of the tree therefore all observations and measurements are estimated.	overgrown group of small to medium sized tree, mainly alder spp, some gaps in tree group with thick bramble and elder ground cover noted, some patches of knotweed evident, appears to have received little recent management		3	28.28

## 9.0 Appendix 1B – Detailed Tree Survey Data Summary

(Please see Appendix 3 - Tree Survey Key)

Field Usage Results.		
Total Records: 1		
Type	Count	% of Total
G	1	100
Average Stem Diameter	Count	% of Total
<500	1	100
Cat	Count	% of Total
C2	1	100
Age	Count	% of Total
EM	1	100
Height	Count	% of Total
<15	1	100
Phy Cond	Count	% of Total
G/F	1	100
Stuc Cond	Count	% of Total
N/A	1	100
Est. Remain Contrib	Count	% of Total
20+	1	100
RPR	Count	% of Total
<5	1	100
RPA	Count	% of Total
<30	1	100

## 9.0 Appendix 2 - Tree Constraints Plan

### An introduction to the Tree Constraints Plan (TCP)

Trees identified to be retained should be treated as constraints to the design of future development. A Tree Constraints Plan has been drawn and can be found overleaf.

- **Tree Quality** - The TCP highlights the above and below-ground constraints each tree poses to the design of future development schemes. Further, the BS5837 tree quality category (A - High, B - Moderate, C - Low and U- Unsuitable for retention) are coloured coded as solid circles at the centre of the trees' position.
- **Root Protection Area** – A magenta circle on the TCP sets out the root protection area (RPA). No construction work in this area, ground-level alteration or site traffic (machinery or persons) should occur. This will prevent damage to tree roots and soil compaction. (Where possible, an Arboriculturist can design suitable tree protection methods to facilitate construction work/site traffic within these areas).
- **Tree Canopy** - The jagged green circle/oval on the TCP sets out the above-ground constraints of tree canopy spread. Within this area, no construction work or site traffic (machinery or persons) should occur if the tree is to be retained. This will prevent damage to the tree branches and trunk. (Where possible, an Arboriculturist can design suitable tree protection methods to facilitate construction work/site traffic within these areas).
- **Tree Shading** – Shade from the retained trees should be considered in the development design. Depending on the tree's height and width, the shade cast will be from a North West to East pattern through the central part of the day.
- **Tree Future growth** - Within future development design, consideration should also be given to the ultimate height and extent of the canopy spread of all trees within site identified to be retained.

- KEY BS5837:2012 Tree Quality (Colour Code)**
- Category A (High) ("Highly desirable for retention")
  - Category B (Moderate) ("Desirable for retention")
  - Category C (Low) ("Optional for retention")
  - Category U (Poor) ("Unsuitable for retention")

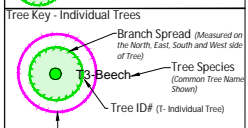

**Root Protection Area (RPA)** (A layout design tool indicating the minimum area around a tree deemed to contain sufficient roots and rooting volume to maintain the tree's viability, and where the protection of the roots and soil structure is treated as a priority.)

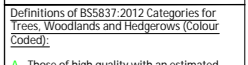
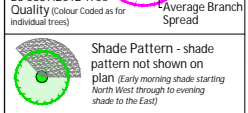
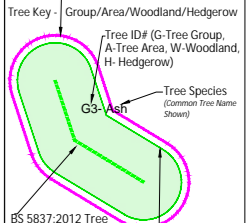

**Definitions of BS5837:2012 Categories for Trees, Woodlands and Hedgerows (Colour Code):**

- A** - Those of high quality with an estimated remaining life expectancy of at least 40 years. ("Highly desirable for retention")
- B** - Those of moderate quality with an estimated remaining life expectancy of at least 20 years. ("Desirable for retention")
- C** - Those of low quality with an estimated remaining life expectancy of at least 10 years, or young trees with a stem diameter below 150mm. ("Optional for retention")
- U** - Those in such a condition that they cannot realistically be retained as living trees in the context of the current land use for longer than 10 years. ("Unsuitable for retention unless provides high conservation value")

**Please Note:**  
Barriers and Ground Protection must be designed by an arboriculturist, installed before materials or machinery is brought onto site and before any demolition, development or stripping of soil commences. Once erected, barriers and ground protection should be regarded as sacrosanct, and should not be removed or altered without prior recommendation by an Arboriculturist and approval of the Local Planning Authority (LPA).

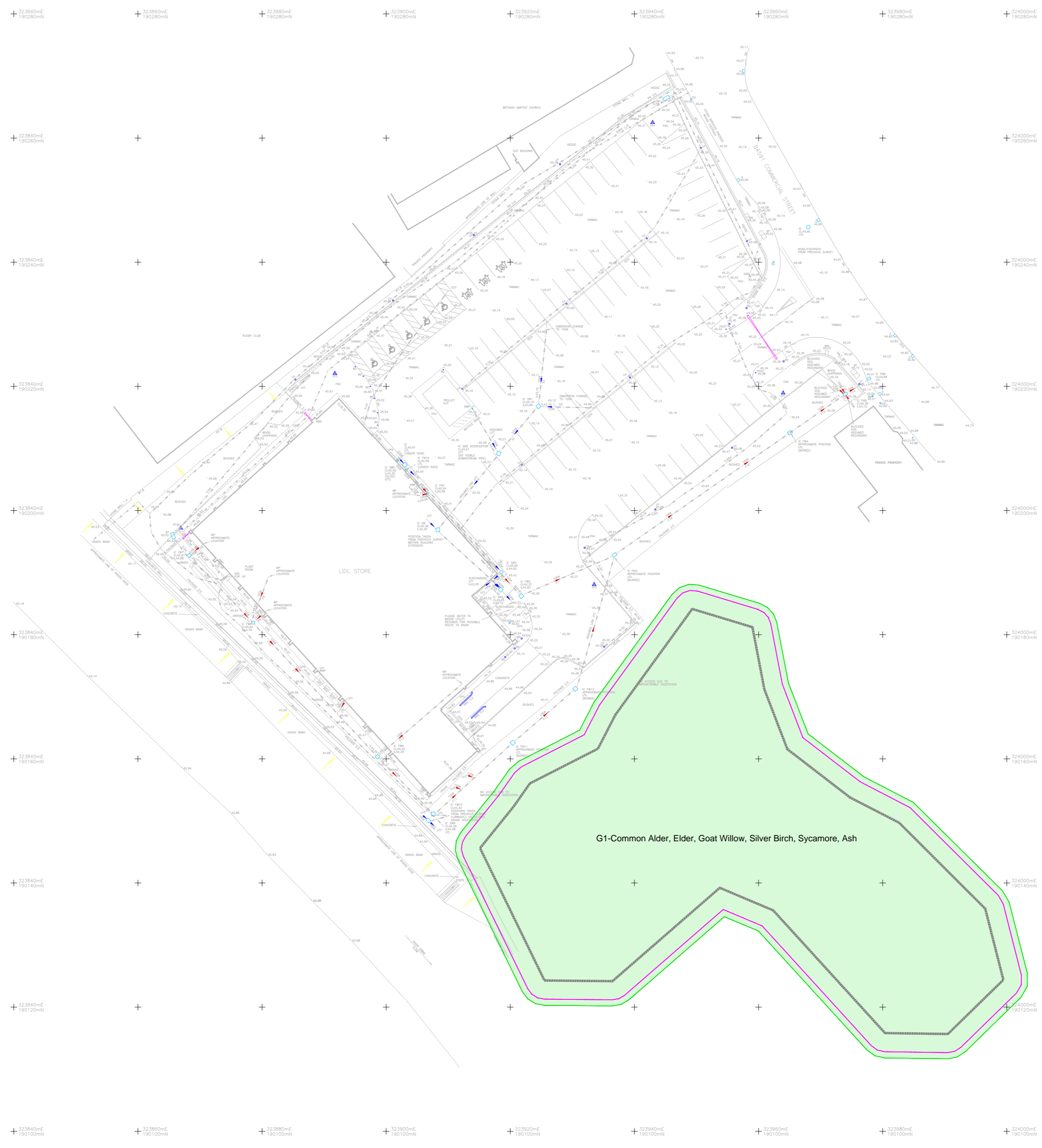

- KEY BS5837:2012 Tree Quality (Colour Code)
- Category A (High) *(Highly desirable for retention)*
  - Category B (Moderate) *(Desirable for retention)*
  - Category C (Low) *(Optional for retention)*
  - Category U (Poor) *(Unsuitable for retention)*

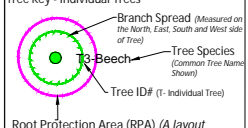

Root Protection Area (RPA) (A layout design tool indicating the minimum area around a tree deemed to contain sufficient roots and rooting volume to maintain the tree's stability, and where the protection of the roots and soil structure is treated as a priority)

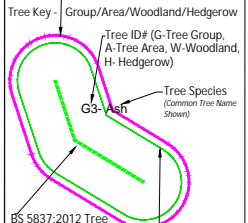

- Definitions of BS5837:2012 Categories for Trees, Woodlands and Hedge/rows (Colour Code)
- A - Those of high quality with an estimated remaining life expectancy of at least 40 years. *(Highly desirable for retention)*
  - B - Those of moderate quality with an estimated remaining life expectancy of at least 20 years. *(Desirable for retention)*
  - C - Those of low quality with an estimated remaining life expectancy of at least 10 years, or young trees with a stem diameter below 150mm. *(Optional for retention)*
  - U - Those in such a condition that they cannot realistically be retained as living trees in the context of the current land use for longer than 10 years. *(Unsuitable for retention unless provides high conservation value)*

**Please Note:**  
Barriers and Ground Protection must be designed by an arboriculturist, installed before materials or machinery is brought onto site and before any demolition, development or stripping of soil commences. Once erected, barriers and ground protection should be regarded as sacrosanct, and should not be removed or altered without prior recommendation by an Arboriculturist and approval of the Local Planning Authority (LPA).



G1-Common Alder, Elder, Goat Willow, Silver Birch, Sycamore, Ash

## 9.0 Appendix 3 - Tree Survey Data Key

- **Tree ID #** - Identifies the location of individual trees (T-ID Number), Groups of trees (G-ID Number), Area of trees (A-ID Number), Hedgerow (H-ID Number), Woodland (W-ID Number), Row of trees (R-ID Number) and tree Stumps (S-ID Number) on the accompanying plan. (*Please note: A group of trees here refers to two or more standing trees that form a visual whole, whereas an area of trees refers to dispersed individual trees standing within the site*)
- **Tree Species** - Scientific names and common tree name in brackets are generally shown.
- **Age**
  - o (Y) Young – Less than 1/3 of life completed
  - o (SM) Middle Aged - 1/3 - 2/3 of life completed
  - o (EM) Early Mature – Just entering Maturity
  - o (M) Mature – more than 2/3 of life completed
  - o (OM) Over Mature - more than 3/3 of life completed and declining
  - o (V) Veteran - (v) Veteran – Veteran trees have no precise definition but are trees considered to be of biological aesthetic or ecological value because of their age
- **Stems** – Number of tree stems used to calculate the RPR/RPA
- **Stem Diam** (mm) - Diameter of tree stem measured in millimetres for single stem trees or average stem diameter calculated for multi-stemmed trees as detailed in section 4.6 & Annex C of the British Standard 5837:2012, Trees in relation to design, demolition and construction - Recommendations. The height above ground level where the stem measurement was taken will be shown if not measured at 1.5 metres above ground level. (*Please note: that the stem diameter of certain trees will have to be estimated due to difficulties in taking measurements or for trees with a large number of stems*)
- **Cat** – Tree Quality Category - British Standard 5837:2012 A, B, C, U + 1, 2, 3

Based on BS5837:2012 categories A, B, C, and U provide the basis for prioritising trees for retention:

- o A – Those of high quality with an estimated remaining life expectancy of at least 40 years. (\*Most desirable for retention\*)
- o B - Those of moderate quality with an estimated remaining life expectancy of at least 20 years. (\*Desirable for retention\*)
- o C – Those of low quality with an estimated remaining life expectancy of at least 10 years, or young trees with a stem diameter below 150mm. (\*Optional for retention\*)
- o U – Those in such a condition that they cannot realistically be retained as living trees in the context of the current land use for longer than 10 years. (\*Unsuitable for retention unless provides high conservation value\*)

Retention Criteria Subcategories: Used for identifying subcategories

E.g. A2 = A high-quality tree with high landscape qualities (further details can be found in British Standard 5837:2012, Trees in relation to design, demolition and construction - Recommendations UK; British Standards Intuition)

- o 1 – Mainly Arboricultural qualities
- o 2 – Mainly landscape qualities
- o 3 – Mainly cultural values, including conservation
  
- **Height + (Lower Branch Height)** - Tree height in metres and in brackets height in metres of the crown (tree branches) clearance at its lowest point above adjacent ground levels.
  
- **Nrth, Est, Sth, Wst** - Crown Spread (Metres) -Tree branch spread in metres measured in four directions (North, East, South, West) from the trunk.
  
- **Phys Cond** - Physiological Condition Indicating the health of the tree -
  - o (G) Good
  - o (F) Fair
  - o (P) Poor
  - o (D) Dead
  - o (N/A) Not Applicable – unable to thoroughly inspect tree due to surrounding vegetation or access issues.
  
- **Struc Cond** – Structural Condition indicating the structural integrity of the tree -
  - o (G) Good – No, or remediable physical defects or decay
  - o (F) Fair - Physical non-remediable defects or decay present, not presenting imminent danger but should be monitored
  - o (P) Poor - physical non-remediable defects or decay present, tree liable to imminent collapse or loss of major limbs.
  - o (D) Dead
  - o (N/A) Not Applicable – unable to thoroughly inspect tree due to surrounding vegetation or access issues.
  
- **Est. Remain Contrib** - (<10, 10+, 20+, 40+)

The trees estimated remaining contribution in years, recorded as:

  - o <10 – less than 10 years
  - o 10+ – at least 10 years
  - o 20+ – at least 20 years
  - o 40+ – at least 40 years
  
- **Comments** – Additional Comments, if required

- **Preliminary Management Recommendations** – Work Recommendations, including further investigation of suspected defects that require more detailed assessment and pose potential for wildlife habitat.
- **Work Priority** - Work Priority -This gives a work priority rating of preliminary management for each tree.
  - o H - High – Urgent work to be carried out as soon as practicable due to safety reasons (Within 14 days).
  - o H/M - High- Medium – Work to be carried out within 6 months/or before the construction phase begins
  - o M - Medium – Work to be carried out in 12 months
  - o L - Low – After consideration/Re-inspect in 18-24 months
  - o Blank – No work required.
- **RPR** – Root protection radius / **RPA** - Root Protection Area - Is a layout design tool indicating the minimum area around a tree deemed to contain sufficient roots and rooting volume to maintain the tree's viability and where the protection of the roots and soil structure is treated as a priority. RPR is a circular area measured as a radius in metres from the tree's centre, or RPA is an area in metres squared. This area may be changed in shape but not reduced in size, providing adequate protection for the tree's rooting system.



## 9.0 Appendix 4 – An Introduction to Tree Protection

For this report, an introduction is given to tree protection. If required, an Arboricultural Impact Assessment, Tree Protection Plan and Tree Protection Methods Statement can be provided for the finalised development design.

Tree protection methods must be considered and designed by an Arboriculturist. These should then be implemented BEFORE any machinery or materials are brought onto the site and before any demolition, development or stripping of soil commences. The Root Protection Area (RPA) (cyan circles/lines) indicated on the Tree Constraints Plan must be set out and the protective barriers and ground protection installed accordingly for retained trees. The protective barriers and ground protection areas shall be regarded as sacrosanct and shall not be removed or altered without prior recommendation by an Arboriculturist and approval of the LPA.

The areas protected by barrier fencing and ground protection shall be subject to the following restrictions:

- Existing soil levels within the protected areas shall not be altered.
- No excavation of any kind shall take place within the protected areas.
- The protected areas shall not be used for storage of any kind.
- No vehicles or machinery shall be allowed into the areas protected by fencing.
- Should the developer require the above restrictions to be breached for unforeseen reasons, an appropriate work method must be agreed upon with the Local Planning Authority before any work occurs within the protected areas.

Additional precautions outside protected barrier areas and ground protection:

- All underground services should be installed following NJUG Volume 4 Guidelines for the Planning, Installation and Maintenance of Utility Apparatus in Proximity to Trees. The full document is available at <http://www.njug.org.uk/>.
- Building materials and fuels such as oil, bitumen or cement should not be stacked or discharged within 10 metres of the tree's stem.
- Fires will not be lit beneath any tree or in a place where flames could extend to within 10 metres of the outer canopy of any tree.
- Trees to be retained and protected should not be used as anchorage for services or equipment.
- The use of cranes and large machinery on site should be planned and care taken not to damage the tree during the process.

Visits by an Arboriculturist during the construction process should be conducted to ensure all of the above are strictly adhered to.

## 9.0 Appendix 5 – Tree Photographs

Tree ID#G1



Tree ID#G1



Tree ID#G1



Tree ID#G1



Tree ID#G1



Tree ID#G1



