

SLOW ARAF

THIS DRAWING IS COPYRIGHT AND REMAINS THE PROPERTY OF HTC ARCHITECTS. IT MUST NOT BE REPRODUCED, USED, DISCLOSED OR TRANSMITTED TO THIRD PARTIES IN ANY FORM, IN WHOLE OR IN PART, WITHOUT PRIOR WRITTEN PERMISSION.

DO NOT SCALE!
ALL DIMENSIONS SHOULD BE CHECKED ON SITE BEFORE WORK COMMENCES

BOUNDARY BASED ON TITLE DEEDS: WA591812

SUBJECT TO LEVELS REVIEW

SUBJECT TO LANDSCAPE ARCHITECT DESIGN

SUBJECT TO TREE SURVEY AND ECOLOGIST REPORT/REVIEW

SUBJECT TO DRAINAGE DESIGN AND REVIEW

SUBJECT TO FLOOD RISK ASSESSMENT

L10L DESIGN AS PER LATEST STANDARD SPECIFICATION TYPE 1300 JUNE 2024

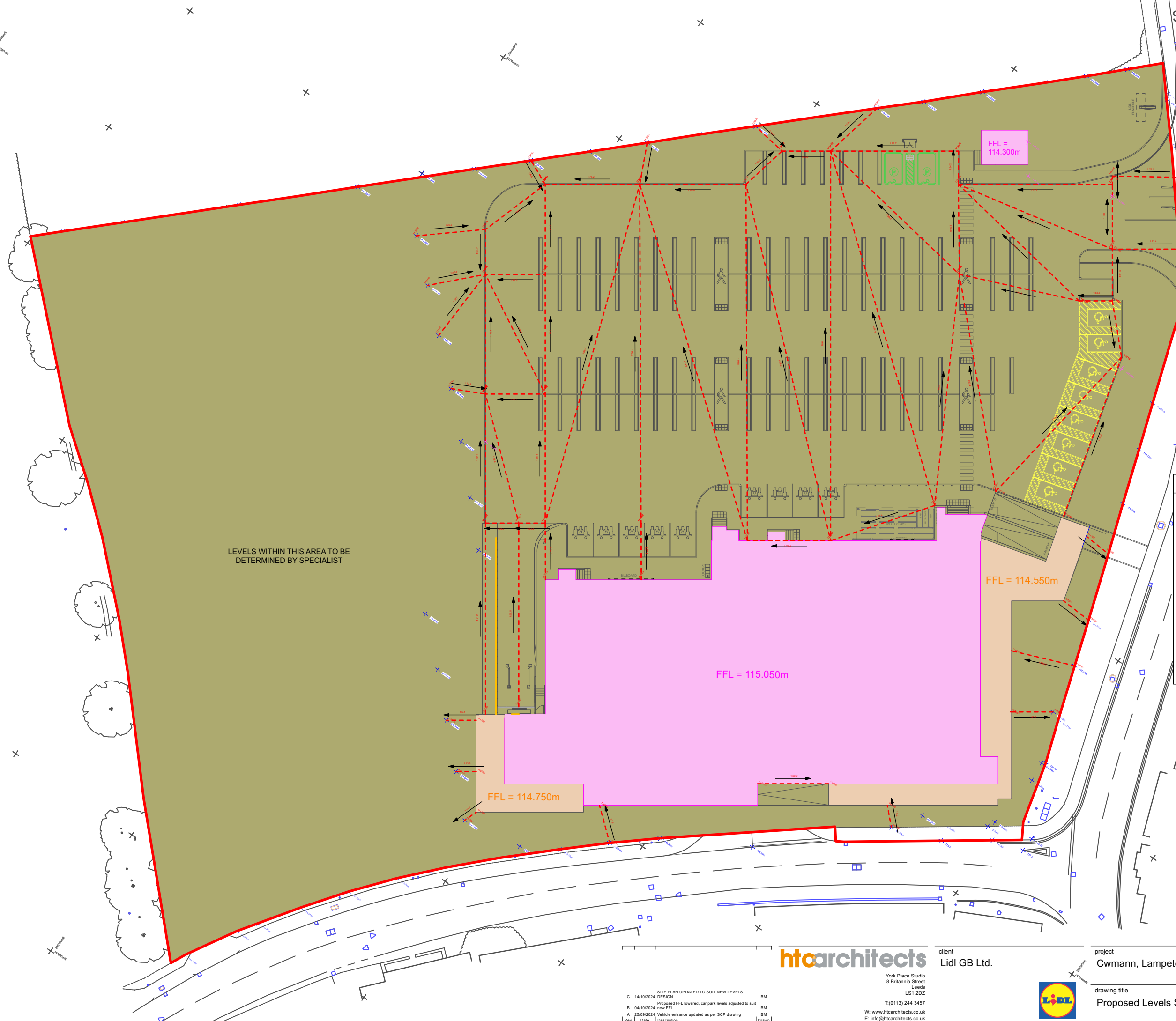
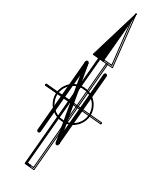

KEY:

- PROPOSED FINISHED FLOOR LEVEL
- EXISTING SPOT LEVEL
- INDICATIVE GULLY POSITION
[SUBJECT TO DRAINAGE CONSULTANT]
- DIRECTION OF FALL - INCLUDING FALL ANGLE SET AT 1:X - OUTSIDE DIMENSIONS INDICATE THE LEVELS (PROPOSED/EXISTING)
ALL PROPOSED LEVELS ARE SUBJECT TO MINOR ADJUSTMENTS AS PER CONSULTANTS DESIGN
- PROPOSED RETAINING WALL
- SITE BOUNDARY

LEVELS WITHIN THIS AREA TO BE DETERMINED BY SPECIALIST

Rev	Date	Description	Drawn
C	14/10/2024	SITE PLAN UPDATED TO SUIT NEW LEVELS	BM
B	04/10/2024	Proposed FFL lowered, car park levels adjusted to suit new FFL	BM
A	25/09/2024	Vehicle entrance updated as per SCP drawing	BM

htcarchitects
York Place Studio
8 Britannia Street
Leeds
LS1 2DZ
T: (0113) 244 3457
W: www.htcarchitects.co.uk
E: info@htcarchitects.co.uk

client
Lidl GB Ltd.



project
Cwmann, Lampeter

drawing title
Proposed Levels Strat

date
September 2024

status
Planning

scale
1:500 @ A3

drawn
BM checked -

job no.
3384 dwg no. P417 rev. C