

THIS DRAWING IS COPYRIGHT AND REMAINS THE PROPERTY OF HTC ARCHITECTS. IT MUST NOT BE REPRODUCED, USED, DISCLOSED OR TRANSMITTED TO THIRD PARTIES IN ANY FORM, IN WHOLE OR IN PART, WITHOUT PRIOR WRITTEN PERMISSION.

DO NOT SCALE!  
ALL DIMENSIONS SHOULD BE CHECKED ON SITE BEFORE WORK COMMENCES

BOUNDARY BASED ON TITLE DEEDS: WA591812

SUBJECT TO LEVELS REVIEW

SUBJECT TO LANDSCAPE ARCHITECT DESIGN

SUBJECT TO TREE SURVEY AND ECOLOGIST REPORT/REVIEW

SUBJECT TO DRAINAGE DESIGN AND REVIEW

SUBJECT TO FLOOD RISK ASSESSMENT

LIDL DESIGN AS PER LATEST STANDARD SPECIFICATION TYPE 1300 JUNE 2024

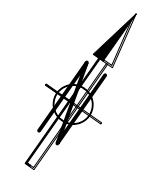

**SURFACE TREATMENT KEY:**

- 200mm x 100mm BLOCK PAVING TO PEDESTRIAN ROUTES AND STORE ENTRANCE. PAVING TO BE LAID IN A STRETCHER BOND PATTERN COLOUR: DARK GREY/ ANTHRACITE
- CONCRETE DELIVERY YARD AND PLANT AREA
- FOOTWAY SMA TO PEDESTRIAN ROUTES.
- 2 BITUMINOUS LAYER TO CAR AND LIGHT VEHICLE CAR PARK LOCATIONS.
- 3 BITUMINOUS LAYER TO ACCESS ROAD AND HGV LOCATIONS
- ANTI -SLIP SURFACE FINISH TO ALL RAMPS
- REFER TO LANDSCAPING ARCHITECTS DRAWINGS AND DETAILS FOR ALL SOFT LANDSCAPING SPECIFICATIONS AND FINISHES
- YELLOW / WHITE & GREEN AS INDICATED THERMOPLASTIC LINING TO DENOTE ALL CAR PARKING SPACES
- BUILDING FOOTPRINT

SURPLUS LAND FOR FLOOD MITIGATION MEASURES - AS PER CONSULTANTS DESIGN

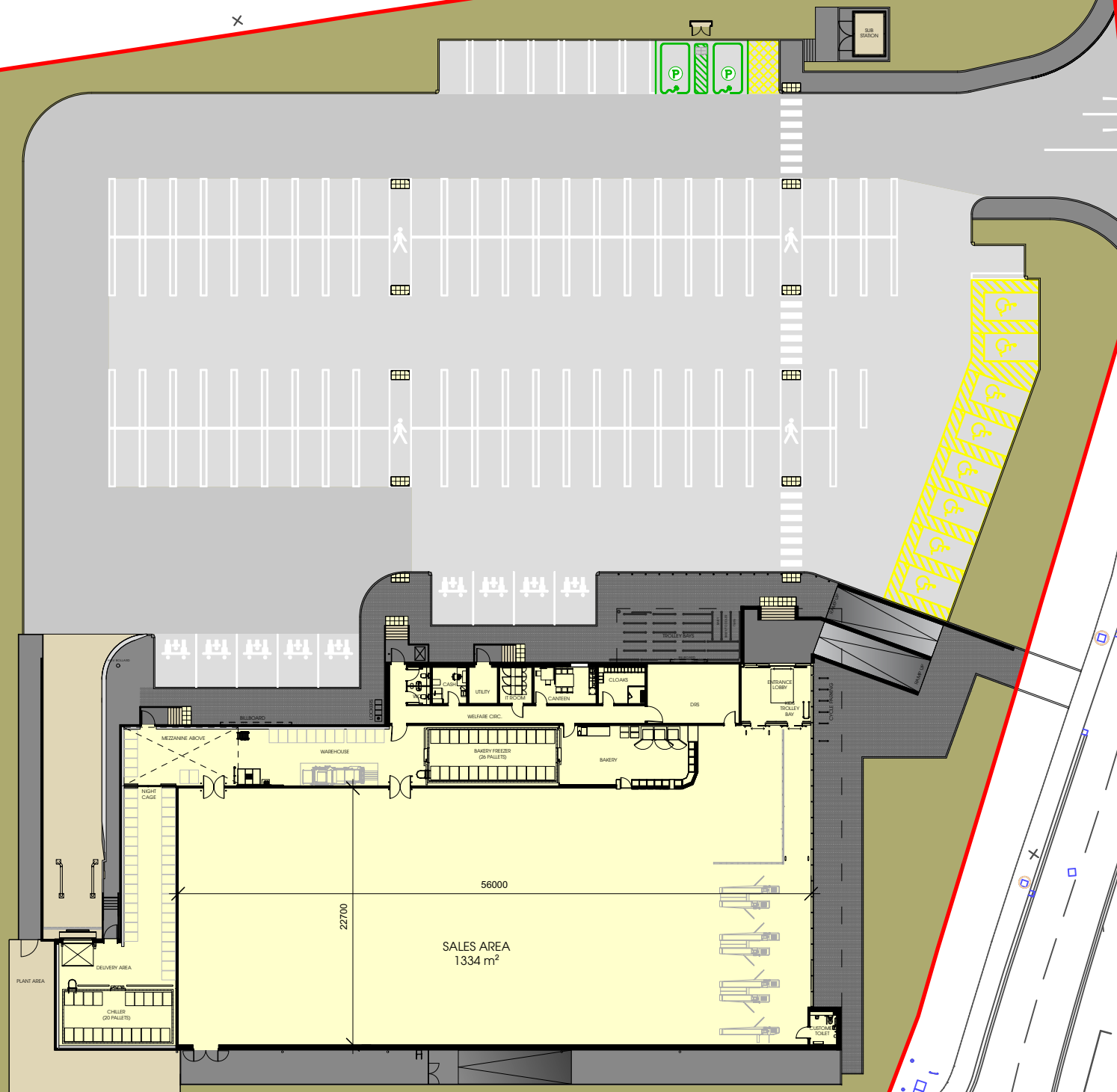

		client <b>Lidl GB Ltd.</b>	project <b>Cwmann, Lampeter</b>	date <b>September 2024</b>															
York Place Studio 8 Britannia Street Leeds LS1 2DZ T:(0113) 244 3457 W: www.htcarchitects.co.uk E: info@htcarchitects.co.uk			drawing title <b>Proposed Surfacing Treatment</b>	status <b>Planning</b>															
<table border="1"> <thead> <tr> <th>Rev</th> <th>Date</th> <th>Description</th> <th>BM</th> <th>BM</th> </tr> </thead> <tbody> <tr> <td>B</td> <td>14/10/2024</td> <td>DESIGN</td> <td></td> <td></td> </tr> <tr> <td>A</td> <td>25/09/2024</td> <td>Vehicle entrance updated as per SCP drawing</td> <td></td> <td></td> </tr> </tbody> </table>		Rev	Date	Description	BM	BM	B	14/10/2024	DESIGN			A	25/09/2024	Vehicle entrance updated as per SCP drawing				scale <b>1:500 @ A3</b>	drawn <b>BM</b>
Rev	Date	Description	BM	BM															
B	14/10/2024	DESIGN																	
A	25/09/2024	Vehicle entrance updated as per SCP drawing																	
				checked <b>-</b>															
				job no. <b>3384</b> dwg no. <b>P413</b> rlv. <b>B</b>															