

THIS DRAWING IS COPYRIGHT, AND REMAINS THE PROPERTY OF HTC ARCHITECTS. IT MUST NOT BE REPRODUCED, USED, DISCLOSED OR TRANSMITTED TO THIRD PARTIES IN ANY FORM, IN WHOLE OR IN PART, WITHOUT PRIOR WRITTEN PERMISSION.

DO NOT SCALE!  
ALL DIMENSIONS SHOULD BE CHECKED ON SITE BEFORE WORK COMMENCES

DESIGN SUBJECT TO FOLLOWING:  
HIGHWAYS ENGINEER DESIGN AND COMMENT  
TREE & TPO SURVEY  
M&E DESIGN  
FLOOD RISK ASSESSMENT  
GROUND INVESTIGATION  
LANDSCAPE ARCHITECTS DESIGN  
LEVELS REVIEW  
DRAINAGE DESIGN  
TITLE DEED REVIEW

LIDL DESIGN BASED OFF OF LATEST BBS 2023 LIDL SPECIFICATION - FEBRUARY 2024

HIGHWAYS DRAWINGS BASED ON CORUN DRAWING: 23-03849 PL01 Rev 8 Potential Ghost Island Junction

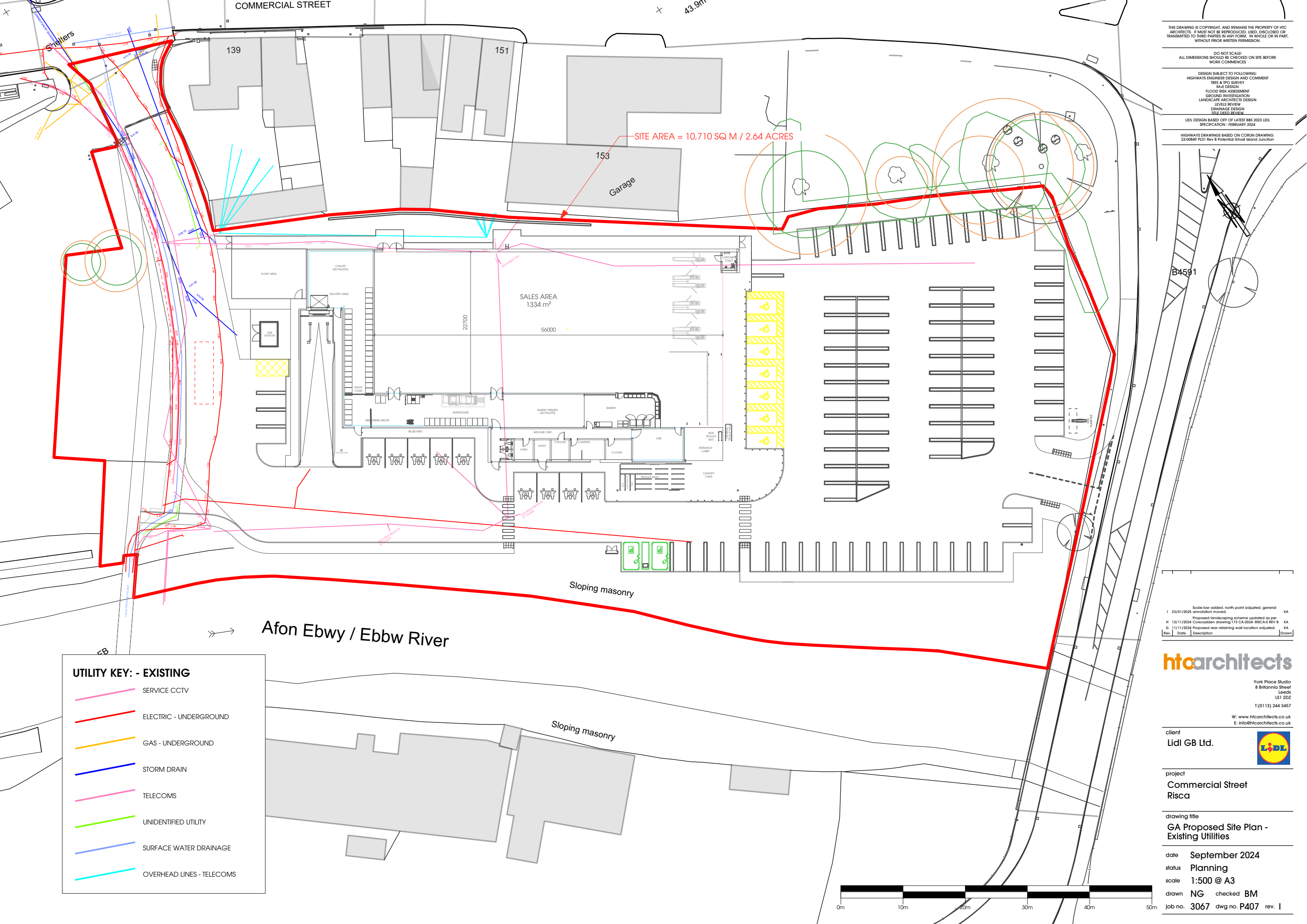

SITE AREA = 10,710 SQ M / 2.64 ACRES

**UTILITY KEY: - EXISTING**

- SERVICE CCTV
- ELECTRIC - UNDERGROUND
- GAS - UNDERGROUND
- STORM DRAIN
- TELECOMS
- UNIDENTIFIED UTILITY
- SURFACE WATER DRAINAGE
- OVERHEAD LINES - TELECOMS

Scale bar added, north point adjusted, general KA  
I 23/01/2025 annotation moved.

Rev.	Date	Description	Drawn
H	13/11/2024	Proposed landscaping scheme updated as per	KA
G	11/11/2024	Corroded drawing 173 CA-2024-RISCA-RREV 8	KA
Rev.	Date	Description	Drawn

**htcarchitects**

York Place Studio  
8 Britannia Street  
Leeds  
LS1 2DZ  
T: (0113) 244 3457  
W: www.htcarchitects.co.uk  
E: info@htcarchitects.co.uk

client  
**Lidl GB Ltd.**



project  
**Commercial Street  
Risca**

drawing title  
**GA Proposed Site Plan -  
Existing Utilities**

date **September 2024**  
status **Planning**  
scale **1:500 @ A3**  
drawn **NG** checked **BM**  
job no. **3067** dwg no. **P407** rev. **1**

