

THIS DRAWING IS COPYRIGHT, AND REMAINS THE PROPERTY OF HTC ARCHITECTS. IT MUST NOT BE REPRODUCED, USED, DISCLOSED OR TRANSMITTED TO THIRD PARTIES IN ANY FORM, IN WHOLE OR IN PART, WITHOUT PRIOR WRITTEN PERMISSION.

DO NOT SCALE!
ALL DIMENSIONS SHOULD BE CHECKED ON SITE BEFORE WORK COMMENCES

TREES TO BE REMOVED SUBJECT TO ARBORICULTURAL REPORT. PROPOSED TREES INDICATIVE ONLY.

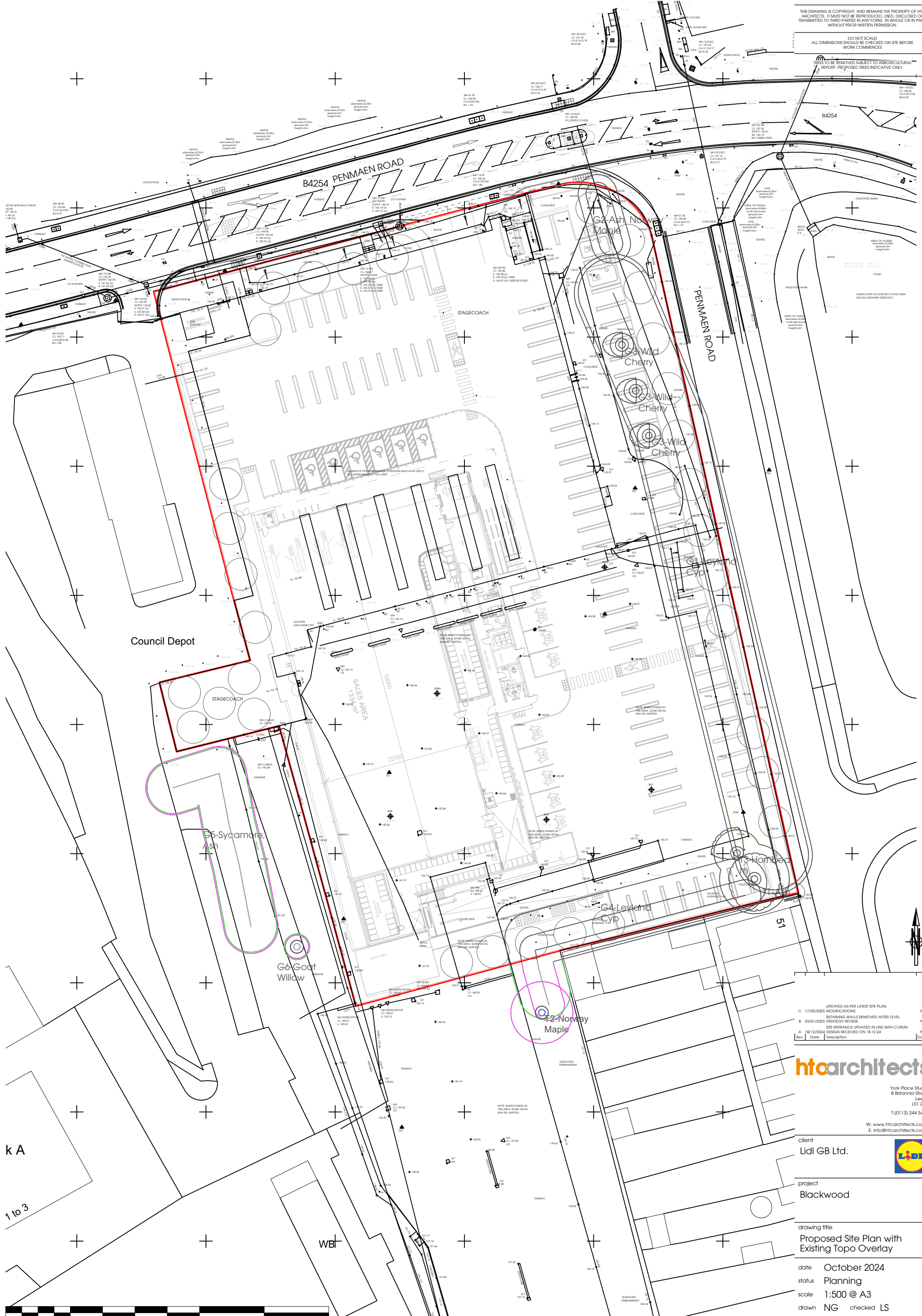

Council Depot

G5 Sycamore Ash

G6 Goat Willow

G2 Norway Maple

G4 Leyland Cyp

G5 Hornbeam

G3 Wild Cherry

G3 Wild Cherry

G3 Wild Cherry

G3 Wild Cherry

G3 Wild Cherry

G3 Wild Cherry

G3 Wild Cherry

G3 Wild Cherry

G3 Wild Cherry

G3 Wild Cherry

G3 Wild Cherry

G3 Wild Cherry

G3 Wild Cherry

G3 Wild Cherry

G3 Wild Cherry

G3 Wild Cherry

G3 Wild Cherry

G3 Wild Cherry

G3 Wild Cherry

G3 Wild Cherry

Updated as per latest site plan	NG		
Retaining walls removed after level	NG		
Strategy review	NG		
Site entrance updated in line with coron	NG		
Design received on 18.12.24	NG		
Rev	Date	Description	Drawn

htcarchitects

York Place Studio
8 Britannia Street
Leeds
LS1 2DZ

T: 0113 244 3457

W: www.htcarchitects.co.uk

E: info@htcarchitects.co.uk

client
Lidl GB Ltd.



project
Blackwood

drawing title
Proposed Site Plan with Existing Topo Overlay

date **October 2024**

status **Planning**

scale **1:500 @ A3**

drawn **NG** checked **LS**

job no. **2973** dwg no. **P410** rev. **C**

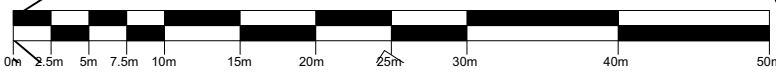

k A

1 to 3

WBI