

SITE AREA = 2.14 ACRES
OR 8657 SQ M

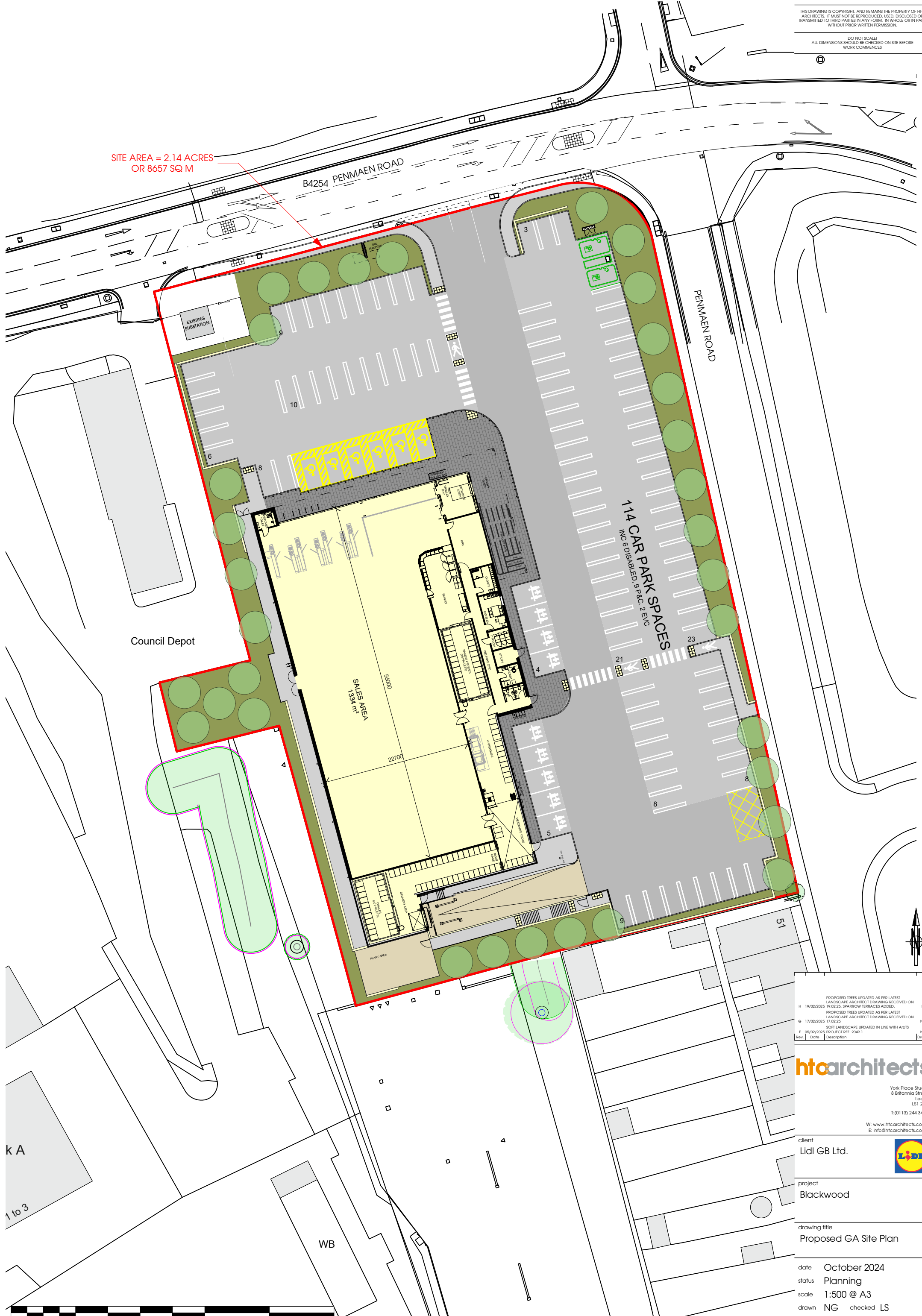

PROPOSED TREES UPDATED AS PER LATEST LANDSCAPE ARCHITECT DRAWING RECEIVED ON 19/02/2025			LS
H	19/02/2025	19.02.25. SPARROW TERRACES ADDED.	
PROPOSED TREES UPDATED AS PER LATEST LANDSCAPE ARCHITECT DRAWING RECEIVED ON 17/02/2025			NG
G	17/02/2025	17.02.25	
SOFT LANDSCAPE UPDATED IN LINE WITH A1D5			NG
F	05/02/2025	PROJECT REF: 2049.1	
Rev	Date	Description	Drawn

htcarchitects
York Place Studio
8 Britannia Street
Leeds
LS1 2DZ
T: (0113) 244 3457
W: www.htcarchitects.co.uk
E: info@htcarchitects.co.uk

client
Lidl GB Ltd.



project
Blackwood

drawing title
Proposed GA Site Plan

date **October 2024**
status **Planning**
scale **1:500 @ A3**
drawn **NG** checked **LS**
job no. **2973** dwg no. **P404** rev. **H**

