

A3

ORIGINAL  
PLOT SIZE

COPYRIGHT RESERVED

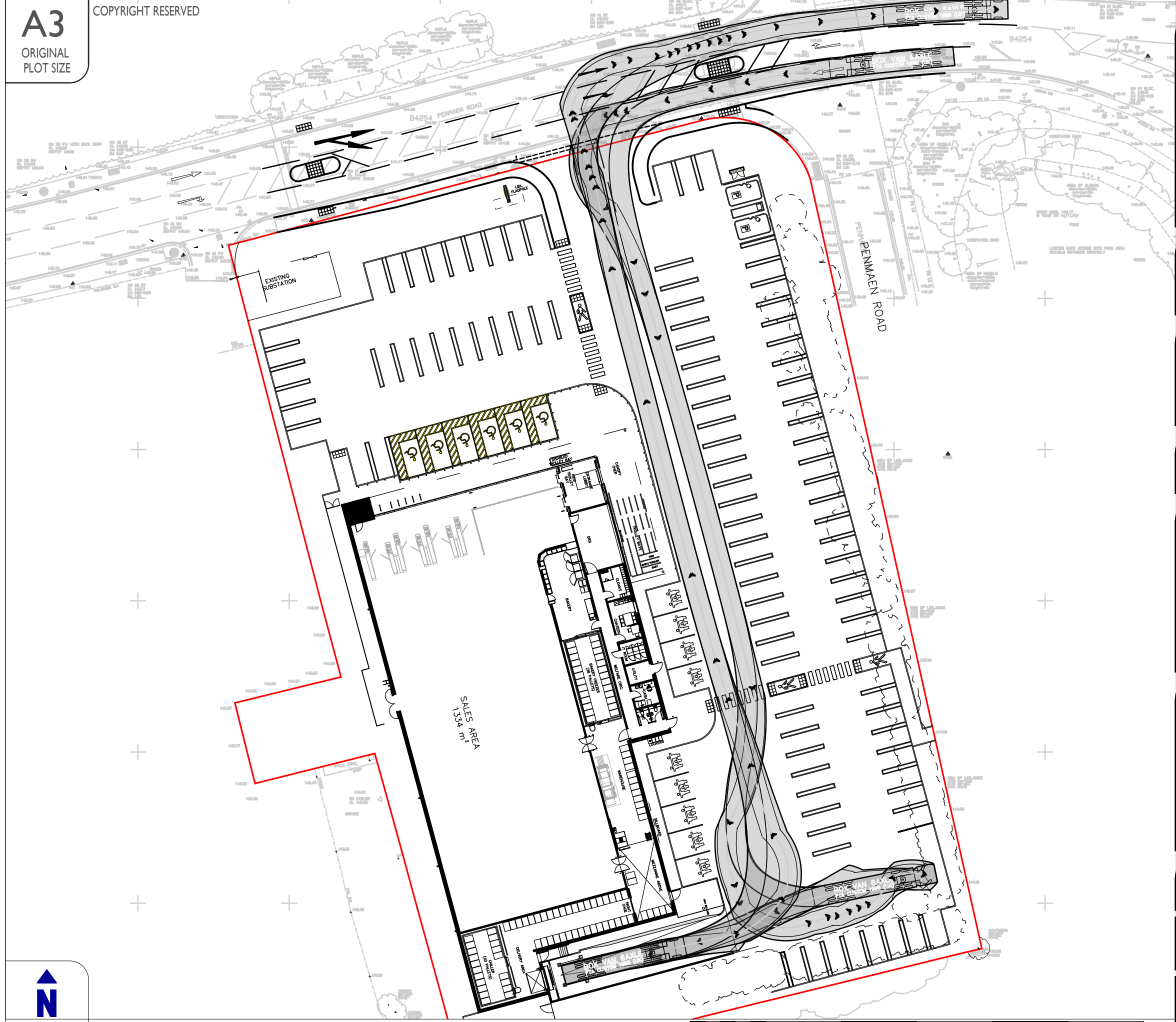

NOTES:

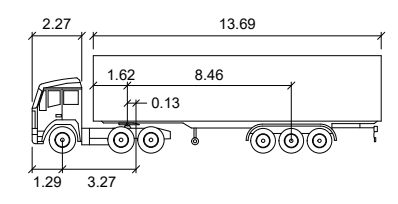

Max Legal Articulated HGV

meters	
Tractor Width : 2.55	Lock to Lock Time : 6.0
Trailer Width : 2.55	Steering Angle : 25.5
Tractor Track : 2.55	Articulating Angle : 70.0
Trailer Track : 2.55	

A	07.02.25	Latest site plan 2973_P403 Rev. E dated 24.01.25 inserted	MP	MA
Rev	Date	Details	Drawn by	Checked by

**CORUN**  
Transport and Highway Engineering

Corun Associates Ltd  
Swansea  
E swansea@corun.uk.com  
W www.corun.uk.com

CLIENT:  
**Lidl Great Britain Ltd**

PROJECT:  
**Penmaen Road  
Blackwood**

TITLE:  
**Swept Path Analysis  
Max Legal (16.5m)  
Articulated HGV**

STATUS:  
**Preliminary**

SCALE: 1:500	DATE: 18.12.24	DRAWN: MP	CHECKED: MA
-----------------	-------------------	--------------	----------------

JOB NO: 24-01027	DRAWING NO: SP01	REVISION: A
---------------------	---------------------	----------------



INDICATIVE

